

The pneumatic lubricator is the simplest way of efficiently lubricating the actuators linked to a circuit. As compressed air flows towards the lubricator, it encounters a flexible diaphragm which partially blocks the way, creating a small pressure difference between the inlet and outlet air. Being at the higher pressure, the oil in the cup is pumped through a tube with a filter towards the regulation pin. The quantity of oil can be metered accurately since the drops can be viewed through the transparent dome. Filling with oil must take place in the absence of pressure, unscrewing the plug next to the dome. On the front and back there is a port (1/8" BSPP for size 1 and 1/4" BSPP for size 2) that can be used with pressure gauges, pressure switches or as an additional air intake.



TECHNICAL DATA	LUB SY1			LUB SY2			
	1/8" NPT	1/4" NPT	3/8" NPT	3/8" NPT	1/2" NPT	3/4" NPT	1" NPT
Threaded port	Oil mist						
Type of lubrication	Manual filling from the top						
Version							
Max. input pressure	bar			bar			
	MPa			MPa			
	psi			psi			
Flow rate at 6.3 bar (0.63 MPa; 91 psi) ΔP 0.5 bar (0.05 MPa; 7.25 psi)	Nl/min	1300	1700	2200	2300	3900	3900
	scfm	46	60	78	81	138	138
Flow rate at 6.3 bar (0.63 MPa; 91 psi) ΔP 1 bar (0.1 MPa; 14.5 psi)	Nl/min	1600	3000	3650	3650	6100	6100
	scfm	57	106	129	129	216	216
Min/max temperature at 10 bar; 1 MPa; 145 psi	°C			°C			
	°F			°F			
Weight	pounds			pounds			
Fluid	Compressed air or other inert gases						
Quantity of filled oil	fluid ounce oz			fluid ounce oz			
Mounting position	Vertical			Vertical			
Port for additional air take-off	1/8" BSPP, front and rear, lubricated air			1/4" BSPP, front and rear, lubricated air			
Additional air take-off flow rate at 6.3 bar (0.63 MPa; 91 psi) ΔP 1 bar (0.1 MPa; 14.5 psi)	Nl/min			Nl/min			
	scfm			scfm			
Wall fixing screws	N. 8-32 unc x 2			N. 10-24 unc x 2			
Recommended oils	ISO and UNI FD22 (Energol HPL; Spinesso; Mobil DTE; Tellus oil)						
Notes on use	Install the lubricator as close as possible to the point of use. Fill the lubricator bowl with oil before pressurizing the system. Do not use cleaning oils, brake fluid oils or solvents in general. For the best lubrication results, set the drip rate to one drop for 11-22 scfm						

COMPONENTS

- ① Technopolymer oil filling plug
- ② Technopolymer flange
- ③ IN/OUT bushing made of OT58 nickel-plated brass or passivated aluminium
- ④ Venturi NBR diaphragm
- ⑤ Technopolymer body
- ⑥ Clear technopolymer bowl
- ⑦ OT 58 brass oil flow regulation needle
- ⑧ Clear technopolymer cover
- ⑨ NBR o-ring gasket
- ⑩ Rilsan[®] oil suction pipe
- ⑪ Oil filter

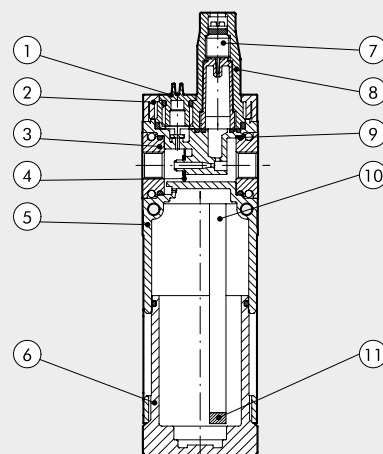

FLOW CHARTS

LUB Syntesi® SY1 1/8"

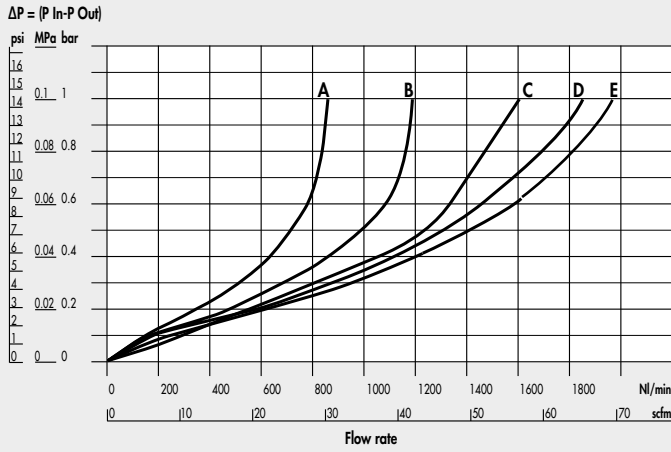

LUB Syntesi® SY1 1/4"

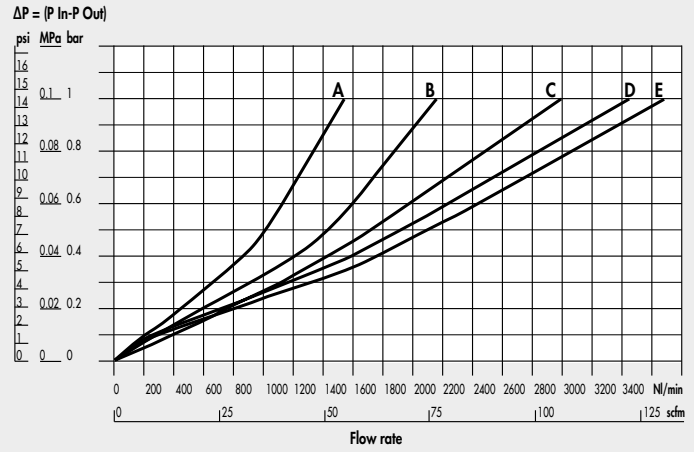

LUB Syntesi® SY1 3/8"

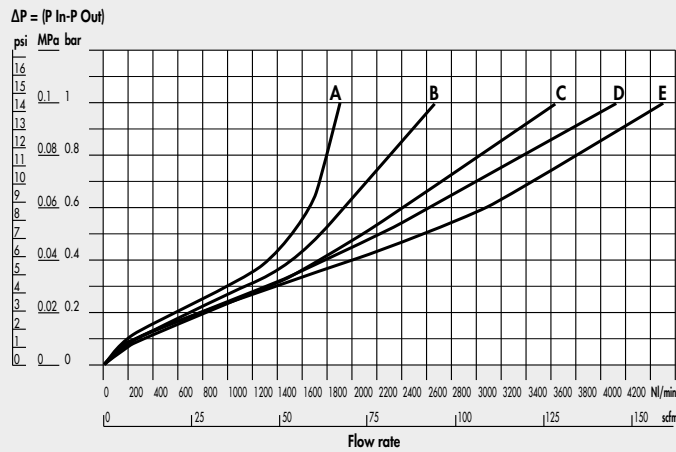

Minimum operating flow chart SY1

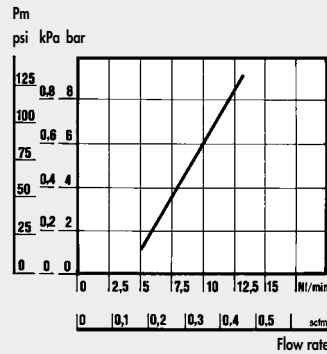

LUB Syntesi® SY2 3/8"

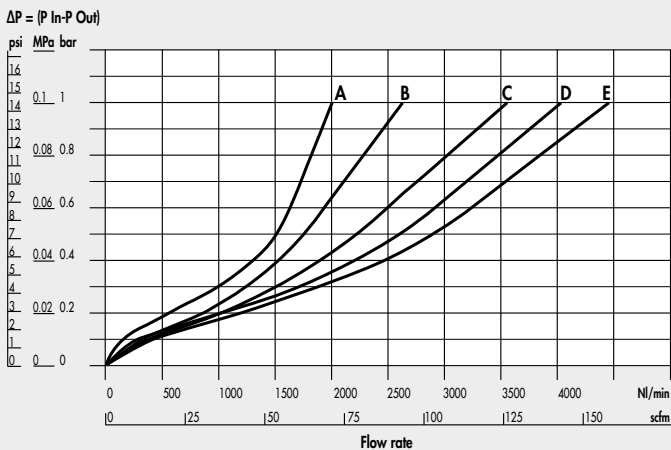

LUB Syntesi® SY2 1/2"

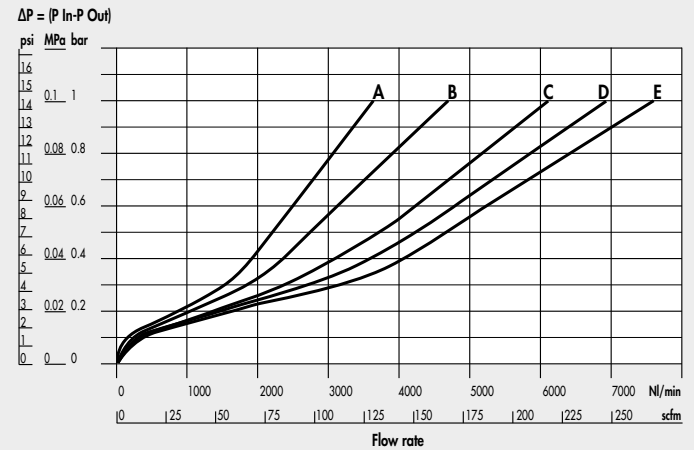

A = 2.5 bar - 0.25 MPa - 36 psi
 B = 4 bar - 0.4 MPa - 58 psi

C = 6.3 bar - 0.63 MPa - 91 psi
 D = 8 bar - 0.8 MPa - 116 psi

E = 10 bar - 1 MPa - 145 psi

LUB Syntesi® SY2 3/4" - 1"

ΔP = (P In-P Out)

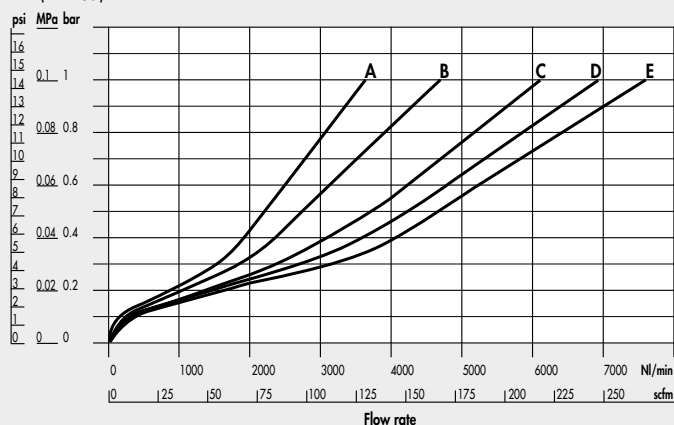

Minimum operating flow chart SY2

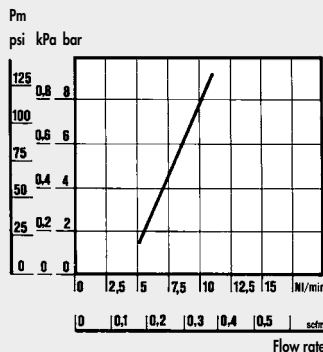

A = 2.5 bar - 0.25 MPa - 36 psi
 B = 4 bar - 0.4 MPa - 58 psi

C = 6.3 bar - 0.63 MPa - 91 psi
 D = 8 bar - 0.8 MPa - 116 psi

E = 10 bar - 1 MPa - 145 psi

DIMENSIONS

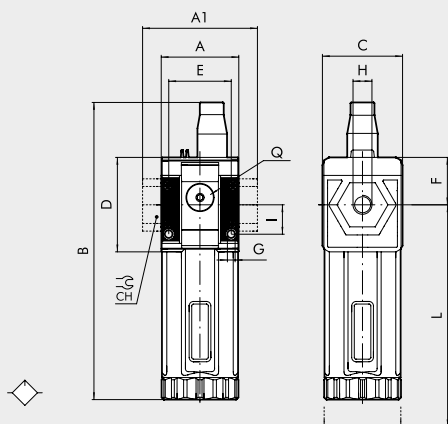

	NPT	SIZE 1			SIZE 2			
		1/8"	1/4"	3/8"	3/8"	1/2"	3/4"	1"
H (threaded port)								
A			1.65				2.38	
A1		-	-	1.73	-	-	3.74	3.74
B			6.38				7.89	
C			1.73				2.4	
CH			-		-	-	1.26	1.41
D			2.03				2.77	
E			1.32				1.87	
F			1.02				1.5	
G			0.165				0.21	
I			0.63				0.89	
L			6.23				7.6	
Q (no. 2 additional air takes-off)			1/8" BSPP				1/4" BSPP	

KEY TO CODES

5U	1	1	L	10	1
SYNTESI	SIZE	THREADED INPUT CONNECTION	ELEMENT	OIL FILLING	THREADED OUTPUT CONNECTION
5U Syntesi NPT	1 Size 1	0 Without bushing 1 1/8" NPT port 2 1/4" NPT port 3 3/8" NPT port	L Lubricator	10 Manual filling from the top	0 Without bushing 1 1/8" NPT port 2 1/4" NPT port 3 3/8" NPT port
5Z Syntesi anti-corrosion NPT	2 Size 2	0 Without bushing 3 3/8" NPT port 4 1/2" NPT port 5 3/4" NPT port 6 1" NPT port			0 Without bushing 3 3/8" NPT port 4 1/2" NPT port 5 3/4" NPT port 6 1" NPT port

PURCHASE ORDER CODES HAVING A MORE FREQUENT USE

N.B. Besides the below mentioned codes, you can order elements composed at your will according to the key to codes.

Code	Description	Code	Description
Syntesi® SY1 LUBRICATOR		Syntesi® SY2 LUBRICATOR	
5U10L100	LUB SY1 NPT without bushings	5U20L100	LUB SY2 NPT without bushings
5U11L101	LUB SY1 1/8 NPT	5U23L103	LUB SY2 3/8 NPT
5U12L102	LUB SY1 1/4 NPT	5U24L104	LUB SY2 1/2 NPT
5U13L103	LUB SY1 3/8 NPT	5U25L105	LUB SY2 3/4 NPT
		5U26L106	LUB SY2 1 NPT

NOTE

Anti-corrosion version

5Z-----

Example

5Z11L101 LUB SY1 1/8 NPT anti-corrosion