

POLY CONN[®]

Master WAIRhouse[®]
Fluid Power Products

**D.O.T. BRASS
PUSH TO CONNECT
FITTINGS**



EMAIL

insidesales@polyconn.com

WEBSITE

www.polyconn.com

QUESTIONS

(763) 559-0388

Features and Specifications for D.O.T. Brass Push to Connect Fittings

SPECIFICATIONS

TEMPERATURE RANGE	PRESSURE RANGE	O-RING MATERIAL
-30°F - 250°F (0°C - 60°C)	0-250 PSI	Viton

FEATURES

- Simply push in tubing for quick connection - no tools or loose parts to handle in tight places.
- Brass construction.
- Elbows and tees are forged brass.
- Pre-applied sealant on all male pipe threads.
- Viton O-Ring sealing in all fittings.
- These fittings meet D.O.T. FMVSS 571.106 Air Brake Performance requirements; SAE J1131, J2494-1 & J2494-3 Air Brake Performance requirements.

USES

- Windows
- Door locks
- Mirrors
- Wipers
- Air Operated Seats
- Operating Gauges
- Air Horns
- Heater Controls
- Gear Shifts
- Fifth Wheels
- Air Brake Connections



Part #	PTC	NPT M	A	B	C	D	List Price	QTY	Pkg. Price
PC54-DOT-42	1/4"	1/8"	22.6	20.6	9.2	21.2	\$ 6.93	5	\$ 34.65
PC54-DOT-44	1/4"	1/4"	19.8	17.8	12.5	19.8	\$ 7.89	5	\$ 39.47
PC54-DOT-46	1/4"	3/8"	19.8	17.8	12.5	23.6	\$ 9.39	5	\$ 46.93
PC54-DOT-62	3/8"	1/8"	23.4	21.4	12.5	17.8	\$ 7.89	5	\$ 39.47
PC54-DOT-64	3/8"	1/4"	23.4	21.4	12.5	20.7	\$ 8.42	5	\$ 42.11
PC54-DOT-66	3/8"	3/8"	24.8	22.8	12.5	21.4	\$ 8.90	5	\$ 44.52
PC54-DOT-68	3/8"	1/2"	22.2	20.2	15.5	28.5	\$ 11.36	5	\$ 56.80
PC54-DOT-84	1/2"	1/4"	25.9	23.9	15.5	21.4	\$ 12.37	5	\$ 61.84
PC54-DOT-86	1/2"	3/8"	25.9	23.9	15.5	22.4	\$ 13.33	5	\$ 66.67
PC54-DOT-88	1/2"	1/2"	30.9	28.9	15.5	32.7	\$ 13.82	5	\$ 69.08
PC54-DOT-106	5/8"	3/8"	27.4	25.4	20.5	27.6	\$ 19.25	5	\$ 96.27
PC54-DOT-108	5/8"	1/2"	27.4	25.4	20.5	32.1	\$ 20.26	5	\$ 101.32
PC54-DOT-128	3/4"	1/2"	34.0	32.0	20.5	31.0	\$ 25.66	5	\$ 128.29
PC54-DOT-1212	3/4"	3/4"	N/A	N/A	N/A	N/A	\$ 32.06	5	\$ 160.31

Measurements are in mm unless otherwise noted.



Part #	PTC	NPT M	A	B	C	D	List Price	QTY	Pkg. Price
PC54-DOTS-42	1/4"	1/8"	22.6	20.6	7/16"	22.9	\$ 7.52	5	\$ 36.62
PC54-DOTS-44	1/4"	1/4"	22.6	20.6	9/16"	28.5	\$ 8.68	5	\$ 43.42
PC54-DOTS-62	3/8"	1/8"	23.4	21.4	7/16"	20.0	\$ 8.46	5	\$ 42.32
PC54-DOTS-64	3/8"	1/4"	23.4	21.4	9/16"	25.6	\$ 8.95	5	\$ 44.74
PC54-DOTS-66	3/8"	3/8"	23.4	21.4	11/16"	25.9	\$ 9.91	5	\$ 49.56
PC54-DOTS-68	3/8"	1/2"	N/A	N/A	N/A	N/A	\$ 13.99	5	\$ 69.96
PC54-DOTS-84	1/2"	1/4"	25.9	23.9	9/16"	27.8	\$ 13.73	5	\$ 68.64
PC54-DOTS-86	1/2"	3/8"	25.9	23.9	11/16"	27.8	\$ 14.65	5	\$ 73.25
PC54-DOTS-88	1/2"	1/2"	25.9	23.9	7/8"	32.6	\$ 17.85	5	\$ 89.25
PC54-DOTS-104	5/8"	1/4"	N/A	N/A	N/A	N/A	\$ 21.71	5	\$ 108.55
PC54-DOTS-108	5/8"	1/2"	27.4	25.4	7/8"	35.7	\$ 21.71	5	\$ 108.55
PC54-DOTS-128	3/4"	1/2"	33.4	31.4	7/8"	35.4	\$ 37.11	5	\$ 185.53
PC54-DOTS-1212	3/4"	3/4"	N/A	N/A	N/A	N/A	\$ 22.68	5	\$ 113.38

Measurements are in mm unless otherwise noted.

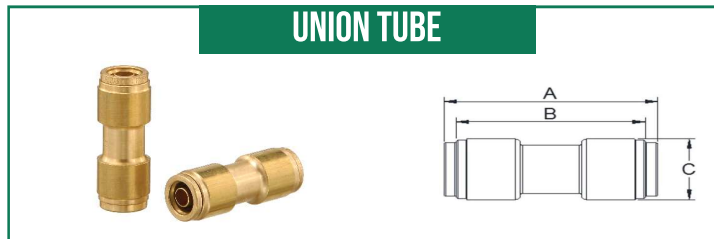

Part #	PTC	A	B	C	List Price	QTY	Pkg. Price
PC62-DOT-1	5/32"	N/A	N/A	N/A	\$ 4.52	5	\$ 22.59
PC62-DOT-4	1/4"	40.9	36.9	12	\$ 4.39	5	\$ 21.93
PC62-DOT-6	3/8"	42.8	38.8	5/8"	\$ 5.31	5	\$ 26.54
PC62-DOT-8	1/2"	46.6	42.6	20	\$ 9.21	5	\$ 46.05
PC62-DOT-10	5/8"	47.6	43.6	25	\$ 19.17	5	\$ 95.83
PC62-DOT-12	3/4"	53.0	49.0	27.5	\$ 19.25	5	\$ 96.27

Measurements are in mm unless otherwise noted.



Part #	PTC	A	B	C	List Price	QTY	Pkg. Price
PC64-DOT-1	5/32"	N/A	N/A	N/A	\$ 12.37	5	\$ 61.84
PC64-DOT-4	1/4"	23.2	21.2	9.2	\$ 10.66	5	\$ 53.29
PC64-DOT-6	3/8"	25.3	23.3	12.5	\$ 11.93	5	\$ 59.65
PC64-DOT-8	1/2"	30.8	28.8	15.5	\$ 14.12	5	\$ 70.61
PC64-DOT-10	5/8"	34.2	32.2	20.5	\$ 25.92	5	\$ 129.61
PC64-DOTR-64	3/8" - 1/4"	N/A	N/A	N/A	\$ 15.31	5	\$ 76.54

Measurements are in mm unless otherwise noted.



Part #	PTC	A	B	C	List Price	QTY	Pkg. Price
PC65-DOT-4	1/4"	27.9	25.9	9.2	\$ 6.97	5	\$ 34.87
PC65-DOT-6	3/8"	31.5	29.5	12.5	\$ 8.68	5	\$ 43.42
PC65-DOT-8	1/2"	38.6	36.6	15.5	\$ 13.46	5	\$ 67.32

Measurements are in mm unless otherwise noted.

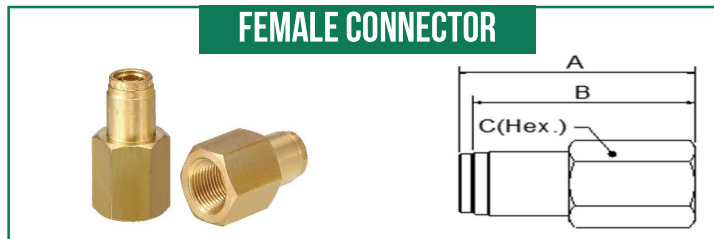

Part #	PTC	NPT F	A	B	C	List Price	QTY	Pkg. Price
PC66-DOT-42	1/4"	1/8"	32.0	30.0	9/16"	\$ 4.30	5	\$ 21.49
PC66-DOT-44	1/4"	1/4"	35.0	33.0	19.0	\$ 5.83	5	\$ 29.17
PC66-DOT-64	3/8"	1/4"	39.0	37.0	19.0	\$ 5.88	5	\$ 29.39
PC66-DOT-66	3/8"	3/8"	40.0	38.0	7/8"	\$ 7.32	5	\$ 36.62
PC66-DOT-68	3/8"	1/2"	42.0	40.0	1-1/8"	\$ 12.85	5	\$ 64.25
PC66-DOT-84	1/2"	1/4"	38.0	36.0	7/8"	\$ 9.87	5	\$ 49.34
PC66-DOT-86	1/2"	3/8"	38.3	36.3	7/8"	\$ 8.55	5	\$ 42.76
PC66-DOT-88	1/2"	1/2"	42.8	40.8	1-1/8"	\$ 9.39	5	\$ 46.93

Measurements are in mm unless otherwise noted.



Servicing Your Pneumatic Needs For Over 40 Years

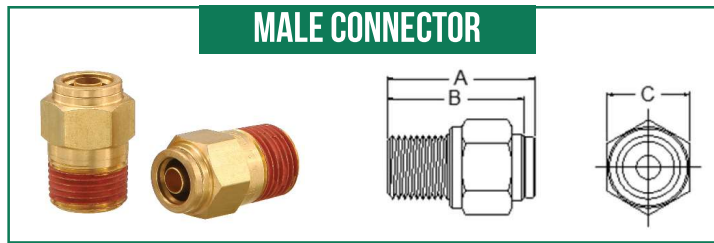

Part #	PTC	NPT M	A	B	C	List Price	QTY	Pkg. Price
PC68-DOT-42	1/4"	1/8"	24.9	22.9	1/2"	\$ 2.89	5	\$ 14.47
PC68-DOT-44	1/4"	1/4"	26.7	24.7	9/16"	\$ 3.86	5	\$ 19.30
PC68-DOT-46	1/4"	3/8"	29.1	27.1	11/16"	\$ 4.78	5	\$ 23.90
PC68-DOT-48	1/4"	1/2"	31.4	29.4	7/8"	\$ 7.46	5	\$ 37.28
PC68-DOT-62	3/8"	1/8"	28.9	26.9	5/8"	\$ 3.68	5	\$ 18.42
PC68-DOT-64	3/8"	1/4"	28.7	26.7	5/8"	\$ 3.64	5	\$ 18.20
PC68-DOT-66	3/8"	3/8"	29.1	27.1	11/16"	\$ 5.22	5	\$ 26.10
PC68-DOT-68	3/8"	1/2"	29.0	27.0	7/8"	\$ 6.97	5	\$ 34.87
PC68-DOT-612	3/8"	3/4"	33.7	31.7	27.0	\$ 15.31	5	\$ 76.54
PC68-DOT-84	1/2"	1/4"	34.7	32.7	13/16"	\$ 6.80	5	\$ 33.88
PC68-DOT-86	1/2"	3/8"	31.1	29.1	13/16"	\$ 7.19	5	\$ 35.97
PC68-DOT-88	1/2"	1/2"	33.4	31.4	7/8"	\$ 7.76	5	\$ 38.82
PC68-DOT-812	1/2"	3/4"	30.7	28.7	27.0	\$ 12.02	5	\$ 60.09
PC68-DOT-106	5/8"	3/8"	36.0	34.0	25.0	\$ 10.22	5	\$ 51.10
PC68-DOT-108	5/8"	1/2"	34.6	32.6	25.0	\$ 10.75	5	\$ 53.73
PC68-DOT-1012	5/8"	3/4"	34.7	32.7	27.0	\$ 12.76	5	\$ 63.82
PC68-DOT-128	3/4"	1/2"	41.4	39.4	27.0	\$ 12.76	5	\$ 63.82
PC68-DOT-1212	3/4"	3/4"	32.7	30.7	27.0	\$ 13.99	5	\$ 69.96

Measurements are in mm unless otherwise noted.



Part #	PTC	NPT M	A	B	C	D	List Price	QTY	Pkg. Price
PC69-DOT-42	1/4"	1/8"	27.9	25.9	9.2	23.5	\$ 4.47	5	\$ 22.37
PC69-DOT-44	1/4"	1/4"	28.2	26.2	12.5	30.5	\$ 5.57	5	\$ 27.85
PC69-DOT-46	1/4"	3/8"	30.8	28.8	12.5	30.5	\$ 6.23	5	\$ 31.14
PC69-DOT-62	3/8"	1/8"	29.0	27.0	12.5	28.0	\$ 6.18	5	\$ 30.92
PC69-DOT-64	3/8"	1/4"	29.0	27.0	12.5	30.5	\$ 6.71	5	\$ 33.55
PC69-DOT-66	3/8"	3/8"	31.5	29.5	12.5	30.5	\$ 7.06	5	\$ 35.31
PC69-DOT-68	3/8"	1/2"	35.5	33.5	15.5	38.5	\$ 9.82	5	\$ 49.12
PC69-DOT-84	1/2"	1/4"	36.6	34.6	15.5	35.0	\$ 10.04	5	\$ 50.22
PC69-DOT-86	1/2"	3/8"	36.6	34.6	15.5	35.0	\$ 10.48	5	\$ 52.41
PC69-DOT-88	1/2"	1/2"	38.6	36.6	15.5	39.5	\$ 11.18	5	\$ 55.92
PC69-DOT-106	5/8"	3/8"	40.9	38.9	19.0	38.5	\$ 15.04	5	\$ 75.22
PC69-DOT-108	5/8"	1/2"	40.9	38.9	19.0	42.0	\$ 15.88	5	\$ 79.39
PC69-DOT-128	3/4"	1/2"	50.2	48.2	20.5	47.0	\$ 18.20	5	\$ 91.01
PC69-DOT-1212	3/4"	3/4"	N/A	N/A	N/A	N/A	\$ 18.55	5	\$ 92.76

Measurements are in mm unless otherwise noted.



Part #	PTC	NPT M	A	B	C	D	List Price	QTY	Pkg. Price
PC69-DOTS-42	1/4"	1/8"	27.9	25.9	7/16"	28.6	\$ 6.10	5	\$ 30.48
PC69-DOTS-44	1/4"	1/4"	27.9	25.9	9/16"	34.1	\$ 6.75	5	\$ 33.77
PC69-DOTS-46	1/4"	3/8"	27.9	25.9	11/16"	33.4	\$ 6.84	5	\$ 34.21
PC69-DOTS-48	1/4"	1/2"	27.9	25.9	7/8"	38.2	\$ 9.87	5	\$ 49.34
PC69-DOTS-62	3/8"	1/8"	29.0	27.0	7/16"	30.1	\$ 7.15	5	\$ 35.75
PC69-DOTS-64	3/8"	1/4"	29.0	27.0	9/16"	36.0	\$ 7.15	5	\$ 35.75
PC69-DOTS-66	3/8"	3/8"	29.0	27.0	11/16"	35.9	\$ 7.89	5	\$ 39.47
PC69-DOTS-68	3/8"	1/2"	29.0	27.0	7/8"	40.8	\$ 11.40	5	\$ 57.02
PC69-DOTS-612	3/8"	3/4"	29.0	27.0	27.0	44.2	\$ 18.11	5	\$ 90.57
PC69-DOTS-84	1/2"	1/4"	36.6	34.6	9/16"	40.2	\$ 11.62	5	\$ 58.11
PC69-DOTS-86	1/2"	3/8"	36.6	34.6	11/16"	39.9	\$ 12.37	5	\$ 61.84
PC69-DOTS-88	1/2"	1/2"	36.6	34.6	7/8"	44.7	\$ 14.17	5	\$ 70.83
PC69-DOTS-812	1/2"	3/4"	38.6	36.6	27.0	48.2	\$ 18.82	5	\$ 94.08
PC69-DOTS-106	5/8"	3/8"	40.9	38.9	11/16"	43.5	\$ 17.76	5	\$ 88.82
PC69-DOTS-108	5/8"	1/2"	40.9	38.9	7/8"	48.3	\$ 18.95	5	\$ 94.74
PC69-DOTS-126	3/4"	3/8"	50.2	48.2	11/16"	48.3	\$ 18.11	5	\$ 90.57
PC69-DOTS-128	3/4"	1/2"	50.2	48.2	7/8"	51.7	\$ 19.17	5	\$ 95.83
PC69-DOTS-1212	3/4"	3/4"	50.2	48.2	27.0	53.7	\$ 20.79	5	\$ 103.95

Measurements are in mm unless otherwise noted.



Part #	PTC	NPT F	A	B	C	D	List Price	QTY	Pkg. Price
PC70-DOT-42	1/4"	1/8"	28.2	26.2	12.5	27.1	\$ 5.48	5	\$ 27.41
PC70-DOT-44	1/4"	1/4"	35.0	33.0	15.5	30.9	\$ 7.89	5	\$ 39.47
PC70-DOT-46	1/4"	3/8"	N/A	N/A	N/A	N/A	\$ 8.99	5	\$ 44.96
PC70-DOT-64	3/8"	1/4"	35.5	33.5	15.5	38.0	\$ 8.55	5	\$ 42.76
PC70-DOT-66	3/8"	3/8"	35.5	33.5	15.5	37.0	\$ 12.63	5	\$ 63.16
PC70-DOT-86	1/2"	3/8"	38.6	36.6	15.5	37.0	\$ 14.78	5	\$ 73.90
PC70-DOT-88	1/2"	1/2"	42.0	40.0	20.5	48.8	\$ 14.69	5	\$ 73.47

Measurements are in mm unless otherwise noted.



Part #	PTC	NPT F	A	B	C	D	List Price	QTY	Pkg. Price
PC70-DOTS-42	1/4"	1/8"	N/A	N/A	N/A	N/A	\$ 7.68	5	\$ 38.38
PC70-DOTS-44	1/4"	1/4"	27.9	25.9	19.0	40.4	\$ 7.76	5	\$ 38.82
PC70-DOTS-64	3/8"	1/4"	29.0	27.0	19.0	42.4	\$ 9.12	5	\$ 45.61

Measurements are in mm unless otherwise noted.



Part #	PTC	NPT M	A	B	C	D	List Price	QTY	Pkg. Price
PC71-DOT-42	1/4"	1/8"	23.2	21.2	9.2	18.9	\$ 8.90	5	\$ 44.52
PC71-DOT-44	1/4"	1/4"	24.5	22.5	12.5	23.0	\$ 7.81	5	\$ 39.04
PC71-DOT-64	3/8"	1/4"	25.3	23.3	12.5	23.9	\$ 11.10	5	\$ 55.48
PC71-DOT-66	3/8"	3/8"	25.3	23.3	12.5	24.4	\$ 10.04	5	\$ 50.22
PC71-DOT-86	1/2"	3/8"	30.8	28.8	15.5	27.2	\$ 15.53	5	\$ 77.63
PC71-DOT-88	1/2"	1/2"	N/A	N/A	N/A	N/A	\$ 13.16	5	\$ 65.79

Measurements are in mm unless otherwise noted.



Part #	PTC	NPT M	A	B	C	D	List Price	QTY	Pkg. Price
PC71-DOTS-42	1/4"	1/8"	23.2	21.2	7/16"	23.0	\$ 12.46	5	\$ 62.28
PC71-DOTS-44	1/4"	1/4"	23.2	21.2	9/16"	24.0	\$ 10.66	5	\$ 53.29
PC71-DOTS-64	3/8"	1/4"	25.3	23.3	9/16"	29.2	\$ 12.63	5	\$ 63.16
PC71-DOTS-66	3/8"	3/8"	25.3	23.3	11/16"	29.2	\$ 11.10	5	\$ 55.48
PC71-DOTS-86	1/2"	3/8"	30.8	28.8	11/16"	32.2	\$ 20.83	5	\$ 104.17
PC71-DOTS-88	1/2"	1/2"	30.8	28.8	7/8"	36.3	\$ 17.11	5	\$ 85.53

Measurements are in mm unless otherwise noted.

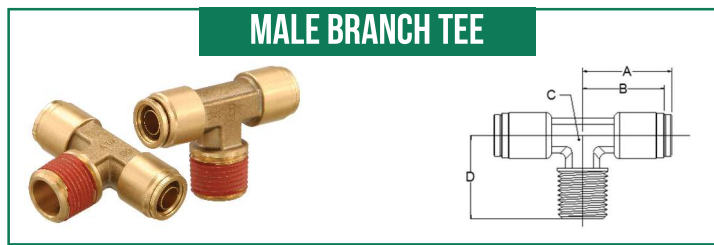

Part #	PTC	NPT M	A	B	C	D	List Price	QTY	Pkg. Price
PC72-DOT-42	1/4"	1/8"	23.2	21.2	9.2	18.9	\$ 8.16	5	\$ 40.79
PC72-DOT-44	1/4"	1/4"	24.5	22.5	12.5	23.7	\$ 8.33	5	\$ 41.67
PC72-DOT-62	3/8"	1/8"	25.3	23.3	12.5	21.2	\$ 9.96	5	\$ 49.78
PC72-DOT-64	3/8"	1/4"	25.3	23.3	12.5	23.7	\$ 10.22	5	\$ 51.10
PC72-DOT-66	3/8"	3/8"	25.3	23.3	12.5	24.2	\$ 13.25	5	\$ 66.23
PC72-DOT-68	3/8"	1/2"	27.1	25.1	15.5	32.6	\$ 17.76	5	\$ 88.82
PC72-DOT-84	1/2"	1/4"	N/A	N/A	N/A	N/A	\$ 14.12	5	\$ 70.61
PC72-DOT-86	1/2"	3/8"	30.8	28.8	15.5	28.0	\$ 14.39	5	\$ 71.93
PC72-DOT-88	1/2"	1/2"	30.8	28.8	15.5	31.7	\$ 15.04	5	\$ 75.22

Measurements are in mm unless otherwise noted.



Part #	PTC	NPT M	A	B	C	D	List Price	QTY	Pkg. Price
PC72-DOTS-42	1/4"	1/8"	23.2	21.2	7/16"	24.1	\$ 11.45	5	\$ 57.24
PC72-DOTS-44	1/4"	1/4"	23.2	21.2	9/16"	29.0	\$ 11.49	5	\$ 57.46
PC72-DOTS-46	1/4"	3/8"	23.2	21.2	11/16"	28.5	\$ 13.16	5	\$ 65.79
PC72-DOTS-62	3/8"	1/8"	25.3	23.3	7/16"	24.4	\$ 11.23	5	\$ 56.14
PC72-DOTS-64	3/8"	1/4"	25.3	23.3	9/16"	29.2	\$ 11.62	5	\$ 58.11
PC72-DOTS-66	3/8"	3/8"	25.3	23.3	11/16"	29.8	\$ 13.42	5	\$ 67.11
PC72-DOTS-84	1/2"	1/4"	30.8	28.8	9/16"	31.8	\$ 13.03	5	\$ 65.13
PC72-DOTS-86	1/2"	3/8"	30.8	28.8	11/16"	32.3	\$ 16.49	5	\$ 82.46
PC72-DOTS-88	1/2"	1/2"	30.8	28.8	7/8"	37.1	\$ 18.77	5	\$ 93.86
PC72-DOTS-108	5/8"	1/2"	N/A	N/A	N/A	N/A	\$ 28.25	5	\$ 141.23

Measurements are in mm unless otherwise noted.

FEMALE BRANCH TEE



Part #	PTC	NPT F	List Price	QTY	Pkg. Price
PC77-DOT-42	1/4"	1/8"	\$ 9.74	5	\$ 48.68
PC77-DOT-44	1/4"	1/4"	\$ 10.61	5	\$ 53.07
PC77-DOT-64	3/8"	1/4"	\$ 14.61	5	\$ 73.03
PC77-DOT-66	3/8"	3/8"	\$ 17.54	5	\$ 87.72

Measurements are in mm unless otherwise noted.

FEMALE BRANCH TEE SWIVEL

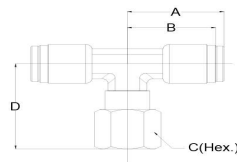

Part #	PTC	NPT F	A	B	C	D	List Price	QTY	Pkg. Price
PC70-DOTS-42	1/4"	1/8"	N/A	N/A	N/A	N/A	\$ 12.72	5	\$ 63.60
PC70-DOTS-44	1/4"	1/4"	N/A	N/A	N/A	N/A	\$ 13.90	5	\$ 69.52
PC70-DOTS-64	3/8"	1/4"	25.3	23.3	19.0	35.6	\$ 14.78	5	\$ 73.90

Measurements are in mm unless otherwise noted.

UNION BULKHEAD

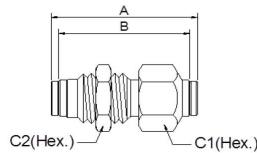

Part #	PTC	A	B	C1	C2	List Price	QTY	Pkg. Price
PC82-DOT-4	1/4"	41.0	37.0	11/16"	11/16"	\$ 8.20	5	\$ 41.01
PC82-DOT-6	3/8"	44.5	40.5	13/16"	13/16"	\$ 10.04	5	\$ 50.22
PC82-DOT-8	1/2"	47.0	43.0	1"	1"	\$ 20.83	5	\$ 104.17
PC82-DOT-10	5/8"	N/A	N/A	N/A	N/A	\$ 25.39	5	\$ 126.97

Measurements are in mm unless otherwise noted.

FEMALE BULKHEAD

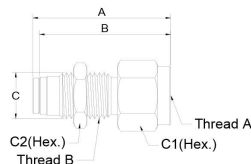

Part #	PTC	NPT F	A	B	C1	C2	List Price	QTY	Pkg. Price
PC86-DOT-42	1/4"	1/8"	N/A	N/A	N/A	N/A	\$ 7.85	5	\$ 39.25
PC86-DOT-44	1/4"	1/4"	41.5	39.5	19.0	11/16"	\$ 8.11	5	\$ 40.57
PC86-DOT-64	3/8"	1/4"	N/A	N/A	N/A	N/A	\$ 8.55	5	\$ 42.76
PC86-DOT-66	3/8"	3/8"	N/A	N/A	N/A	N/A	\$ 10.09	5	\$ 50.44
PC86-DOT-86	1/2"	3/8"	N/A	N/A	N/A	N/A	\$ 11.84	5	\$ 59.21

Measurements are in mm unless otherwise noted.

Now that you have your Fittings, don't
forget your D.O.T. tubing!
D.O.T. Fittings also available in Composite!

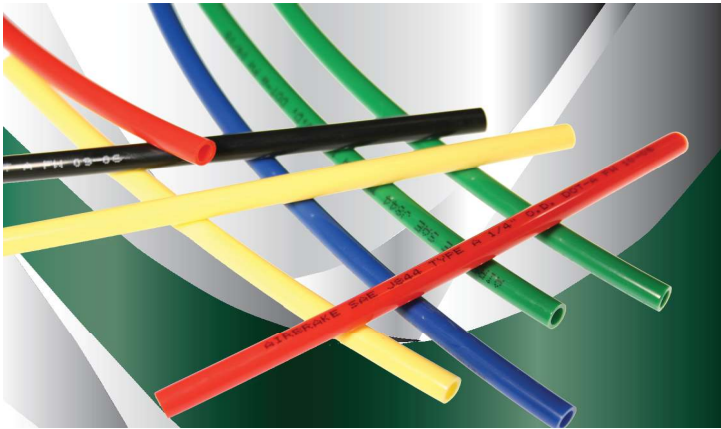

**POLY[®]
CONN**

Servicing Your Pneumatic Needs For Over 40 Years

**Polyconn[®] the one-stop shop for your
pneumatic needs.**