

B-Series Extrusions

TS20-20B

Clear Anodized - 670000

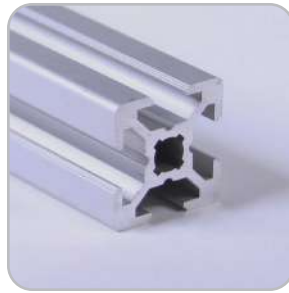
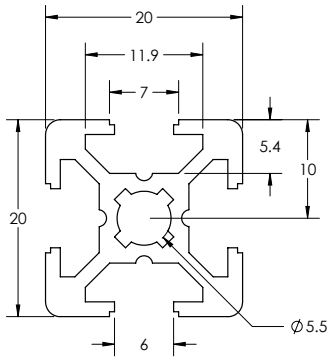

SPECIFICATIONS

Length	118" (3 m)
Weight	0.305 lbs/ft (0.454 kg/m)
Estimated Area	0.254 in ² (1.6383 cm ²)
Moment of Inertia	$I_x=0.016 \text{ in}^4$ (0.67 cm ⁴) $I_y=0.016 \text{ in}^4$ (0.67 cm ⁴)

MACHINE SERVICES

CTL	670500
Single Access Hole	670517
Tap M6	670509

BEAM SELECTION BY LOAD AND LENGTH

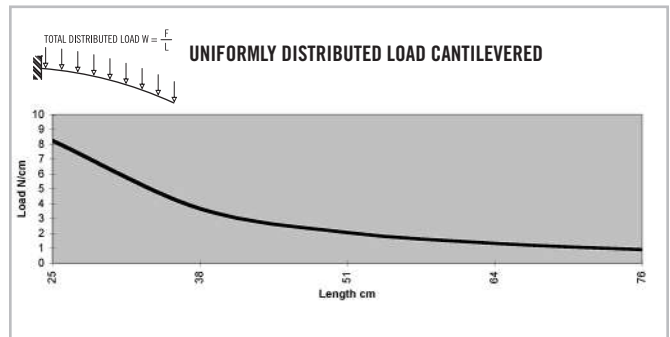
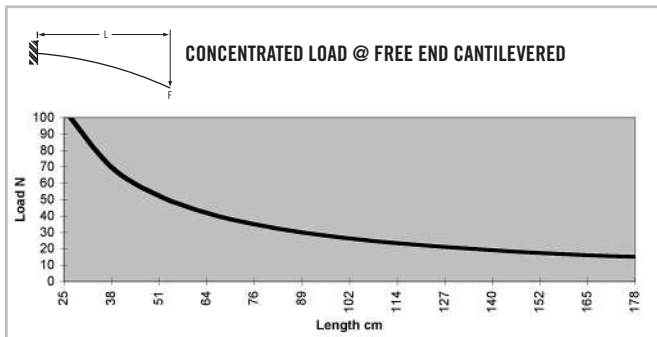
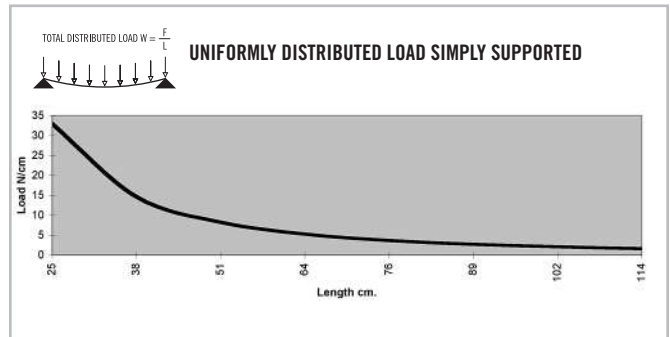
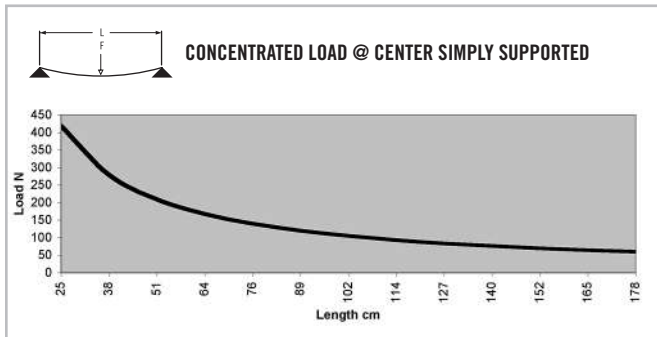

* Charts based on allowable loads related to yield strength with a margin of safety equal to five.

» For deflection equations see page 10

TS20-40B

Clear Anodized - 670004

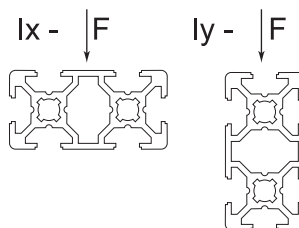
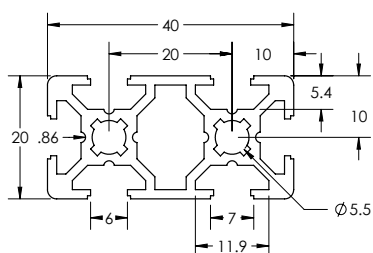

SPECIFICATIONS

Length	118" (3 m)
Weight	0.533 lbs/ft (0.793 kg/m)
Estimated Area	0.444 in ² (2.8638 cm ²)
Moment of Inertia	$I_x=0.029 \text{ in}^4$ (1.21 cm ⁴) $I_y=0.111 \text{ in}^4$ (4.62 cm ⁴)

MACHINE SERVICES

CTL	670501
Single Access Hole	670517
Tap M6	670510

BEAM SELECTION BY LOAD AND LENGTH

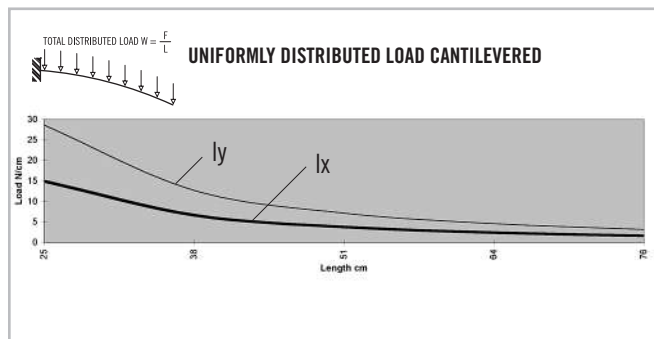
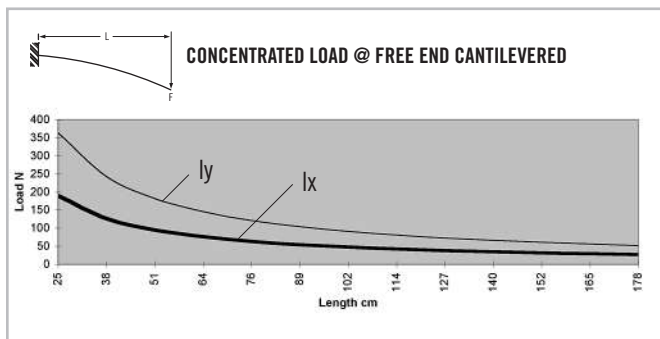
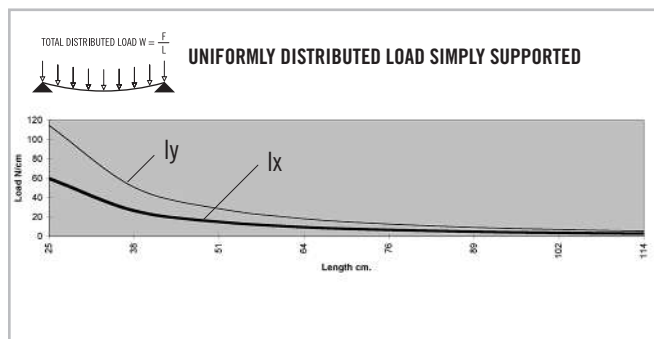
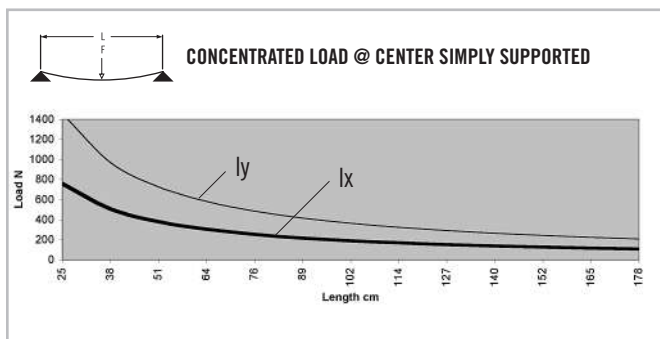

* Charts based on allowable loads related to yield strength with a margin of safety equal to five.

» For deflection equations see page 10

B-Series Extrusions

Clear Anodized - **670007**
 Black Anodized - **670107**
 Yellow Powdercoat - **670207**

TS30-30B

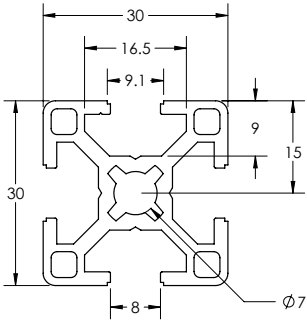

SPECIFICATIONS

Length Clear	239" (6.07 m)
Length Black	239" (6.07 m)
Length Yellow	144" (3.6 m)
Weight	0.588 lbs/ft (0.873 kg/m)
Estimated Area	0.489 in ² (3.15405 cm ²)
Moment of Inertia	$I_x=0.066 \text{ in}^4$ (2.75 cm ⁴) $I_y=0.066 \text{ in}^4$ (2.75 cm ⁴)

MACHINE SERVICES

CTL	670502
Access Hole 7.9mm	670518
Access Hole 11mm	670519
Tap M8	670511

BEAM SELECTION BY LOAD AND LENGTH

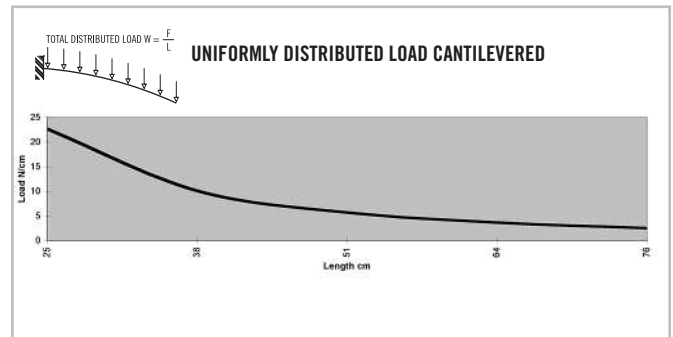
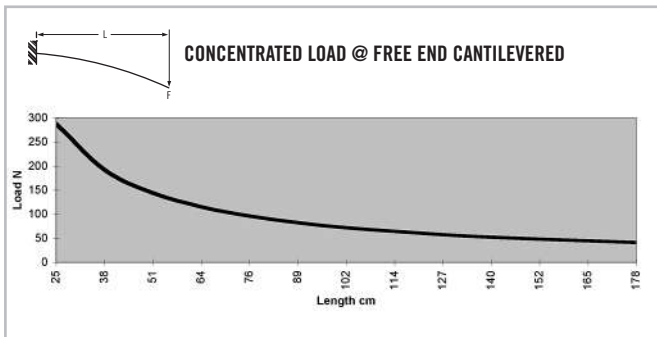
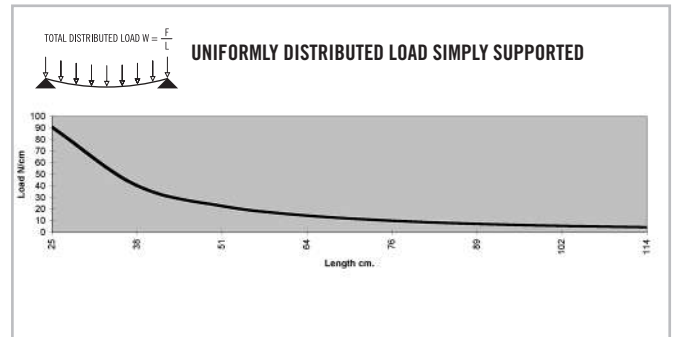
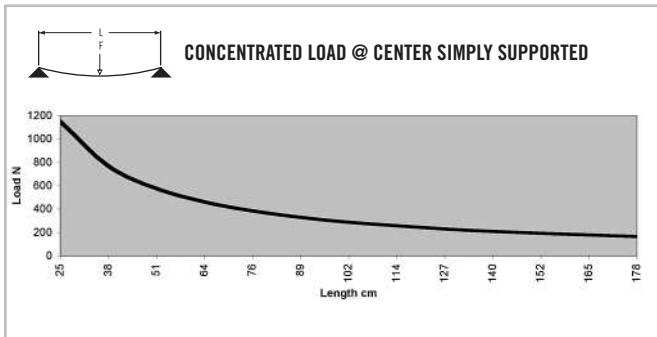

* Charts based on allowable loads related to yield strength with a margin of safety equal to five.

» For deflection equations see page 10

TS30-30B MONOSLOT

Clear Anodized - 670008

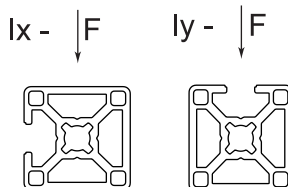
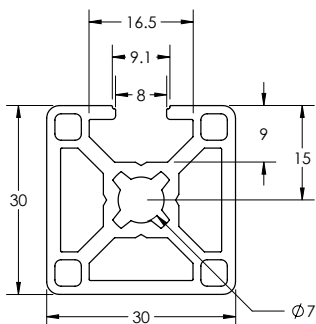

SPECIFICATIONS

Length	239" (6.07 m)
Weight	0.684 lbs/ft (1.017 kg/m)
Estimated Area	0.571 in ² (3.684 cm ²)
Moment of Inertia	$I_x=0.075 \text{ in}^4$ (3.121 cm ⁴)
	$I_y=0.084 \text{ in}^4$ (3.496 cm ⁴)

MACHINE SERVICES

CTL	670502
Access Hole 7.9mm	670518
Access Hole 11mm	670519
Tap M8	670511

BEAM SELECTION BY LOAD AND LENGTH

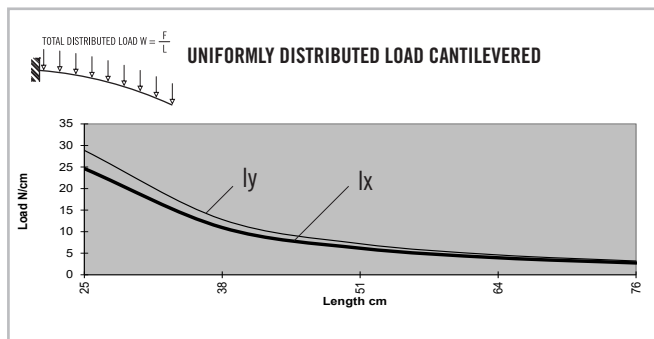
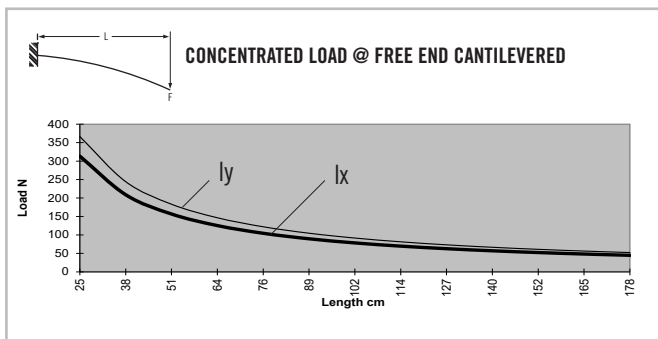
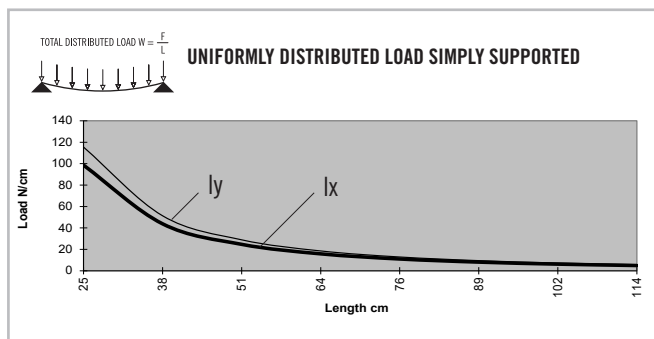
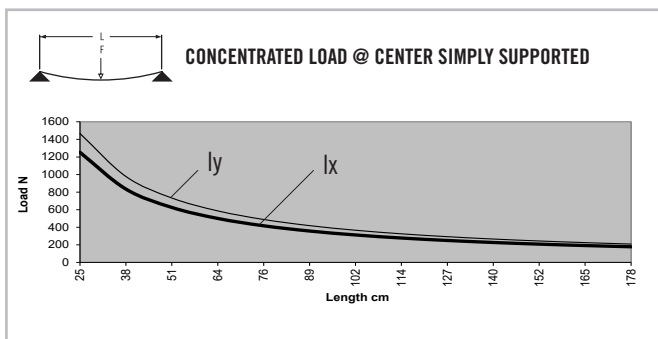

* Charts based on allowable loads related to yield strength with a margin of safety equal to five.

» For deflection equations see page 10

B-Series Extrusions

TS30-30B BISLOT ADJ

Clear Anodized - 670085

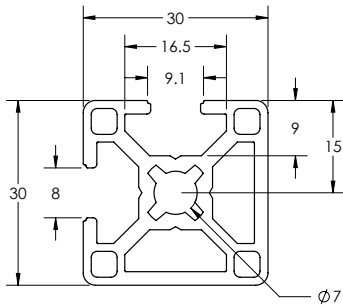

SPECIFICATIONS

Length	239" (6.07 m)
Weight	0.655 lbs/ft (0.975 kg/m)
Estimated Area	0.546 in ² (3.523 cm ²)
Moment of Inertia	$I_x=0.074 \text{ in}^4 (3.080 \text{ cm}^4)$
	$I_y=0.075 \text{ in}^4 (3.122 \text{ cm}^4)$

MACHINE SERVICES

CTL	670502
Access Hole 7.9mm	670518
Access Hole 11mm	670519
Tap M8	670511

BEAM SELECTION BY LOAD AND LENGTH

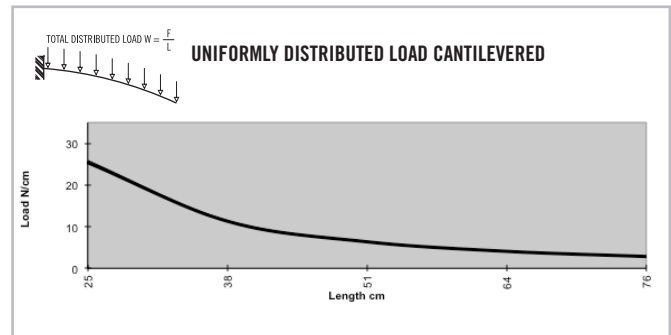
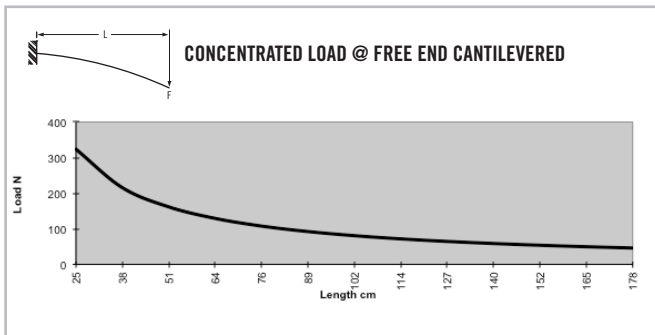
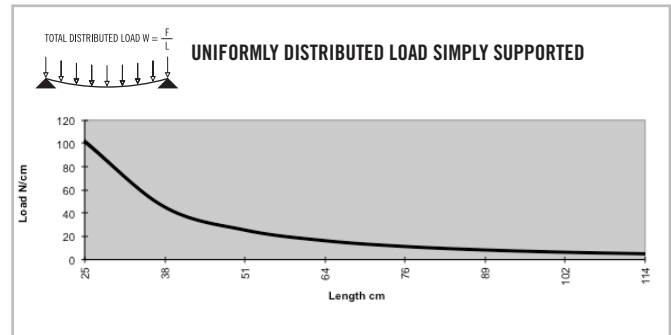
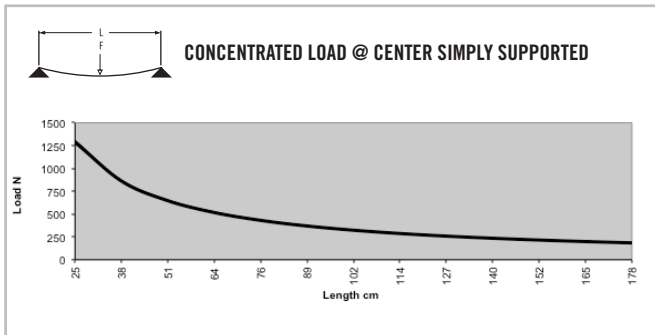

* Charts based on allowable loads related to yield strength with a margin of safety equal to five.

» For deflection equations see page 10

TS30-30B BISLOT OPP

Clear Anodized - 670084

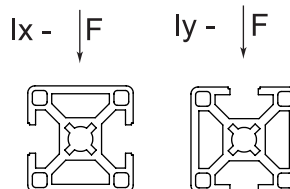
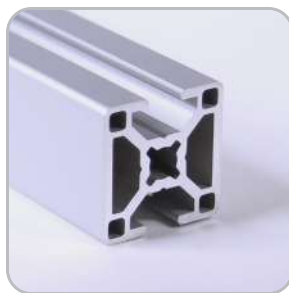
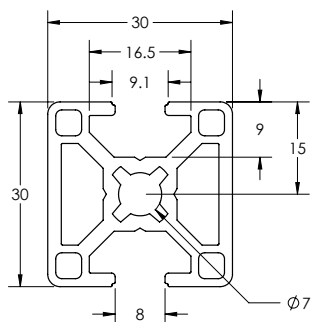

SPECIFICATIONS

Length	239" (6.07 m)
Weight	0.655 lbs/ft (0.975 kg/m)
Estimated Area	0.546 in ² (3.523 cm ²)
Moment of Inertia	lx=0.067 in ⁴ (2.789 cm ⁴)
	ly=0.083 in ⁴ (3.455 cm ⁴)

MACHINE SERVICES

CTL	670502
Access Hole 7.9mm	670518
Access Hole 11mm	670519
Tap M8	670511

BEAM SELECTION BY LOAD AND LENGTH

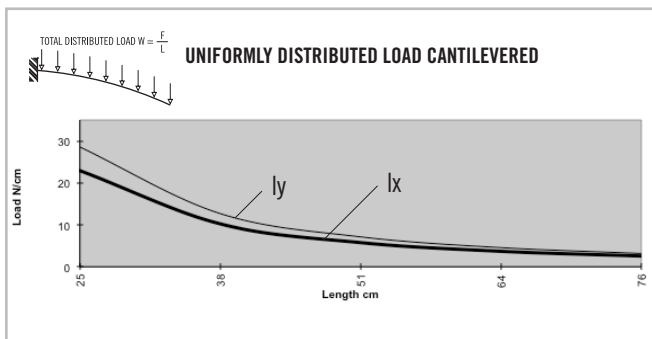
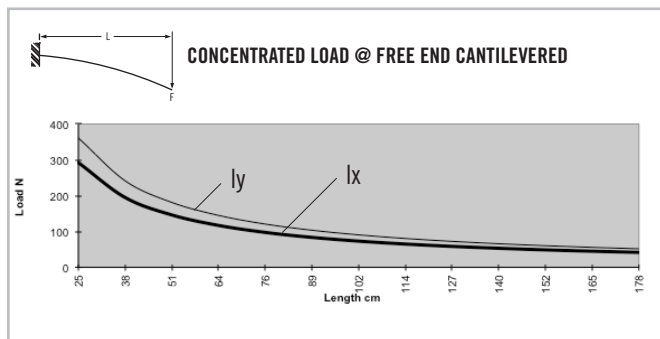
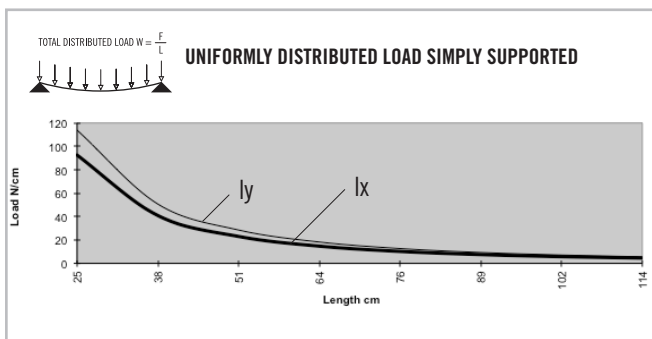
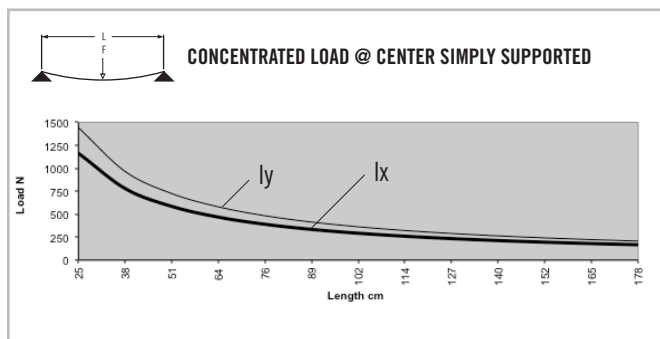

* Charts based on allowable loads related to yield strength with a margin of safety equal to five.

» For deflection equations see page 10

B-Series Extrusions

TS30-30B TRI SLOT

Clear Anodized - 670079

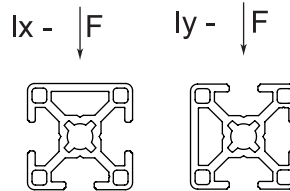
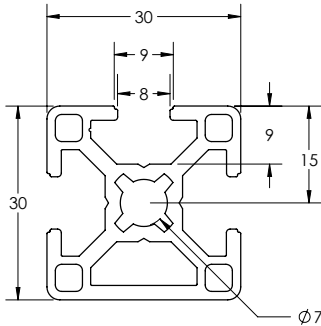

SPECIFICATIONS

Length	239" (6.07 m)
Weight	1.152 lbs/ft (1.714 kg/m)
Estimated Area	0.514 in ² (3.316 cm ²)
Moment of Inertia	I _x =0.067 in ⁴ (2.789 cm ⁴)
	I _y =0.075 in ⁴ (3.121 cm ⁴)

MACHINE SERVICES

CTL	670502
Access Hole 7.9mm	670518
Access Hole 11mm	670519
Tap M8	670511

BEAM SELECTION BY LOAD AND LENGTH

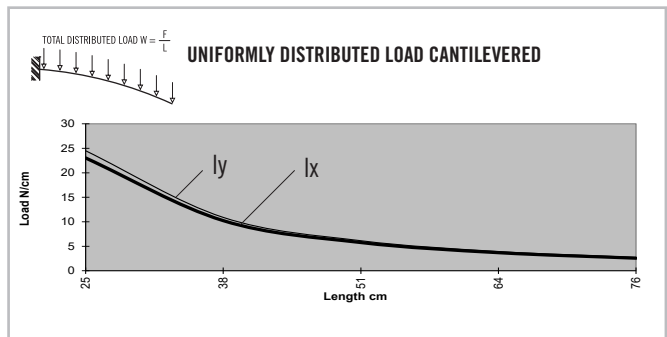
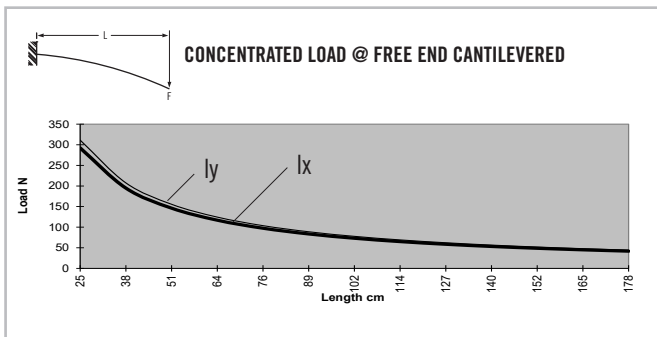
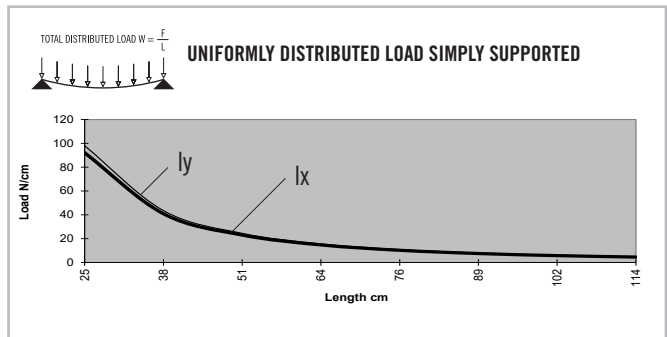
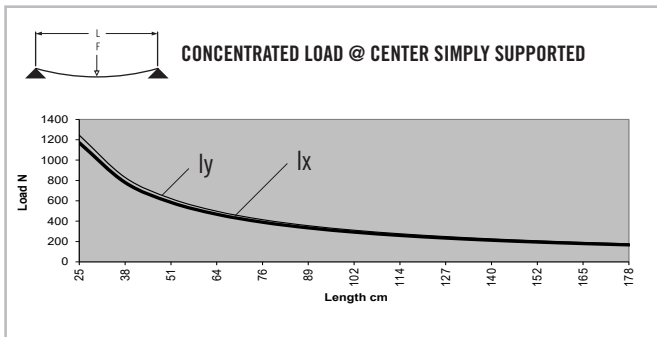

* Charts based on allowable loads related to yield strength with a margin of safety equal to five.

» For deflection equations see page 10

TS30-60RB

Clear Anodized - 670015

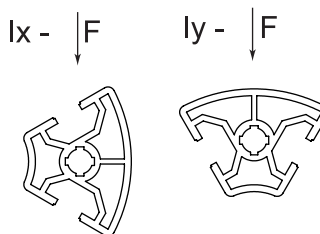
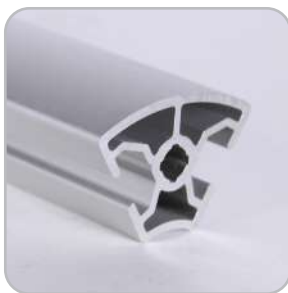
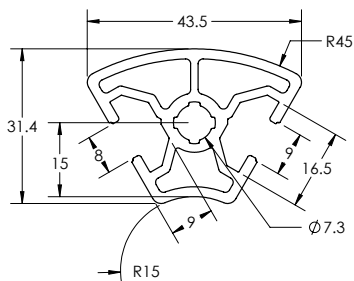

SPECIFICATIONS

Length	239" (6.07 m)
Weight	0.674 lbs/ft (1.0035072 kg/m)
Estimated Area	0.562 in ² (3.6249 cm ²)
Moment of Inertia	I _x =0.074 in ⁴ (3.08 cm ⁴) I _y =0.099 in ⁴ (4.12 cm ⁴)

MACHINE SERVICES

CTL	670503
Access Hole 7.9mm	670518
Access Hole 11mm	670519
Tap M8	670512

BEAM SELECTION BY LOAD AND LENGTH

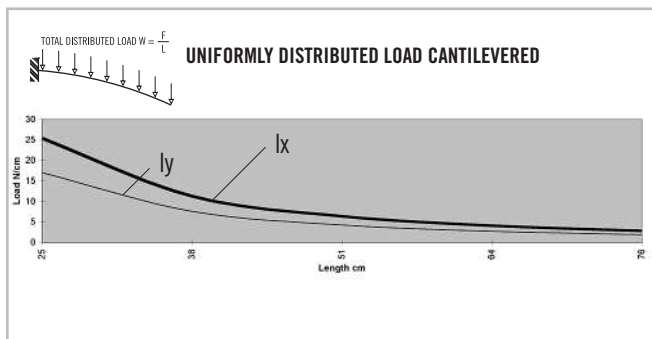
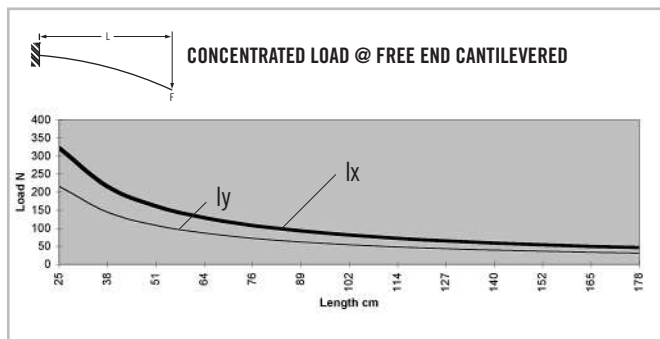
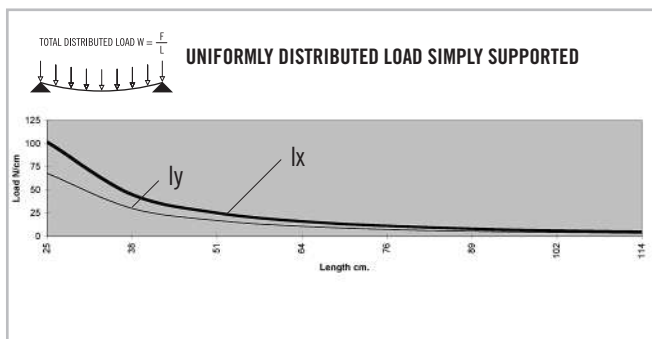
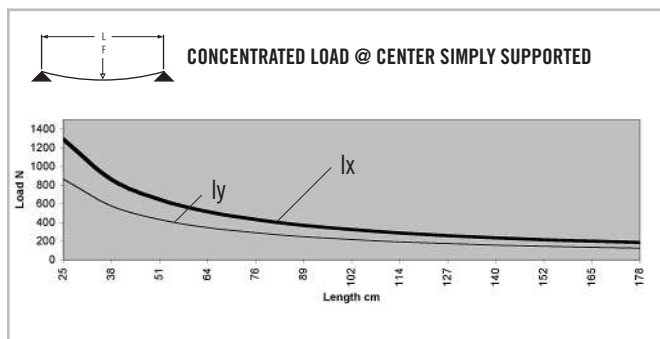

* Charts based on allowable loads related to yield strength with a margin of safety equal to five.

» For deflection equations see page 10

B-Series Extrusions

TS30-60B

Clear Anodized - **670017**
 Black Anodized - **670117**

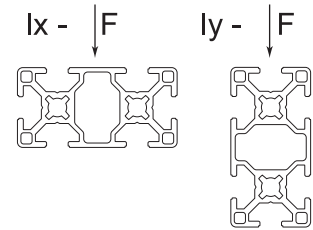
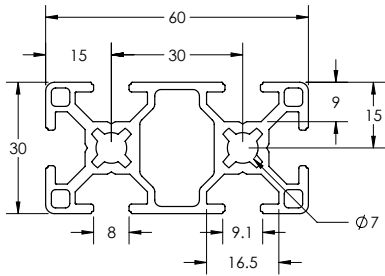

SPECIFICATIONS

Length	239" (6.07 m)
Weight	1.034 lbs/ft (1.539 kg/m)
Estimated Area	0.862 in ² (5.5599 cm ²)
Moment of Inertia	$I_x=0.122 \text{ in}^4$ (5.08 cm ⁴) $I_y=0.473 \text{ in}^4$ (19.69 cm ⁴)

MACHINE SERVICES

CTL	670503
Access Hole 7.9mm	670518
Access Hole 11mm	670519
Tap M8	670512

BEAM SELECTION BY LOAD AND LENGTH

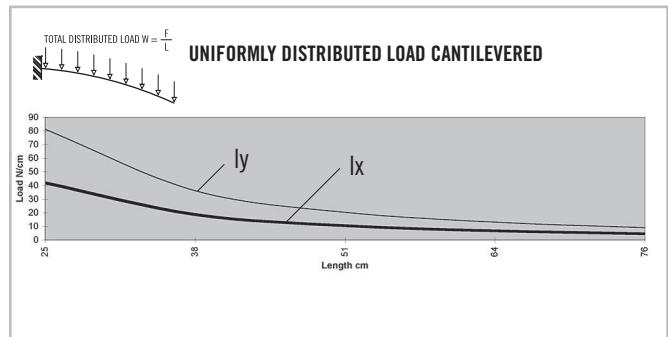
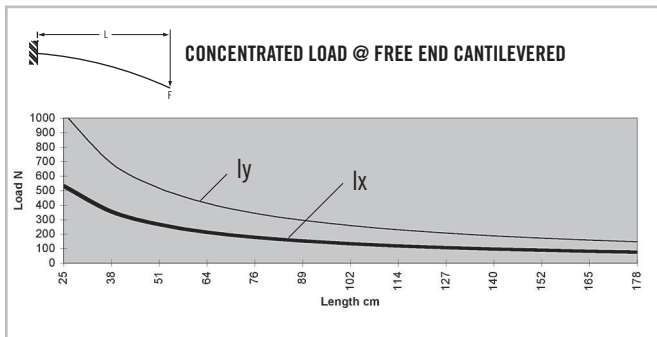
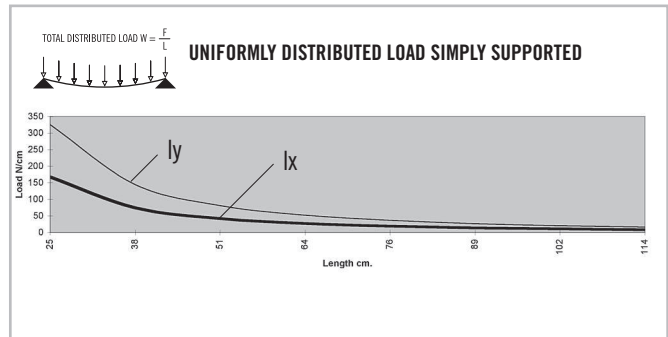
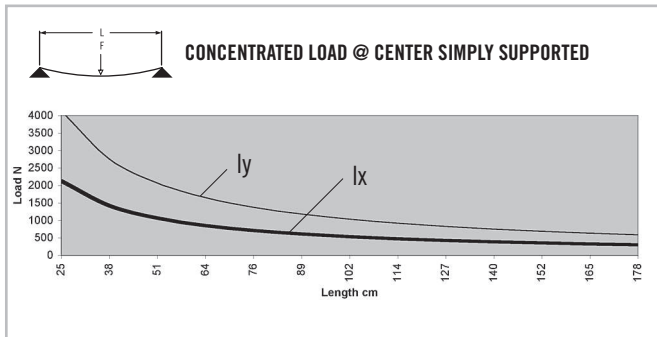

* Charts based on allowable loads related to yield strength with a margin of safety equal to five.

» For deflection equations see page 10

TS30-60B TRI

Clear Anodized - 670087

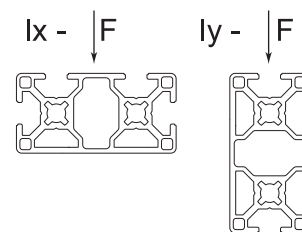
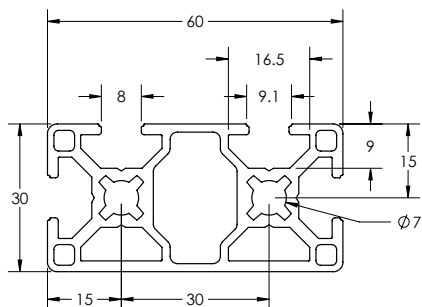

SPECIFICATIONS

Length	239" (6.07 m)
Weight	1.103 lbs/ft (1.64 kg/m)
Estimated Area	0.919 in ² (5.93cm ²)
Moment of Inertia	lx=0.138 in ⁴ (5.744cm ⁴) ly=0.493 in ⁴ (20.52cm ⁴)

MACHINE SERVICES

CTL	670503
Access Hole 7.9mm	670518
Access Hole 11mm	670519
Tap M8	670512

BEAM SELECTION BY LOAD AND LENGTH

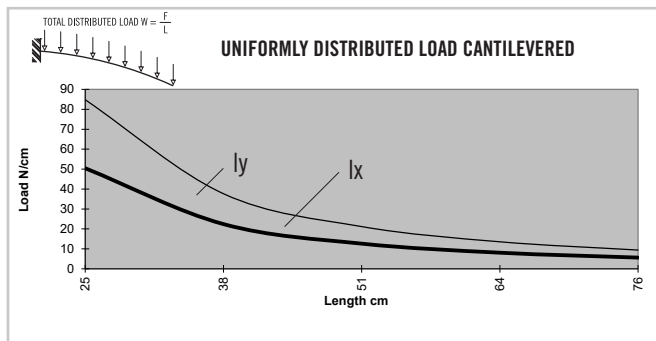
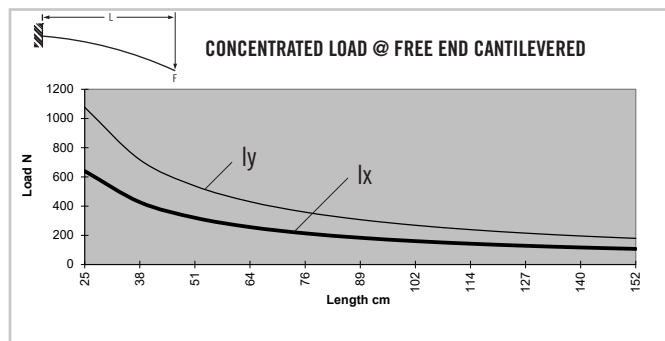
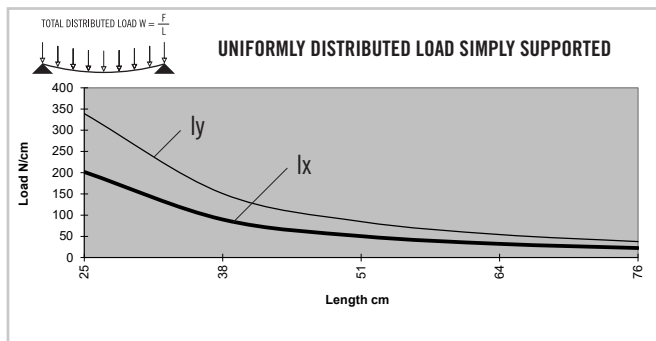
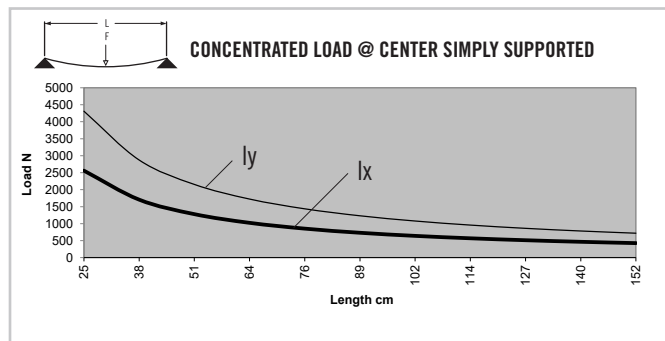

* Charts based on allowable loads related to yield strength with a margin of safety equal to five.

» For deflection equations see page 10

B-Series Extrusions

TS40-40LB

Clear Anodized - 670076

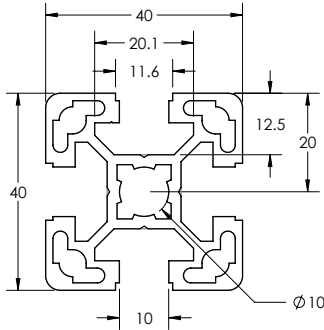

SPECIFICATIONS

Length	239" (6.07 m)
Weight	1.027 lbs/ft (1.529 kg/m)
Estimated Area	0.856 in ² (5.523 cm ²)
Moment of Inertia	I _x =0.217 in ⁴ (9.032 cm ⁴)
	I _y =0.217 in ⁴ (9.032 cm ⁴)

MACHINE SERVICES

CTL	660003
Access Hole 9.8mm	670520
Access Hole 17mm	670521
Tap M12	670513

BEAM SELECTION BY LOAD AND LENGTH

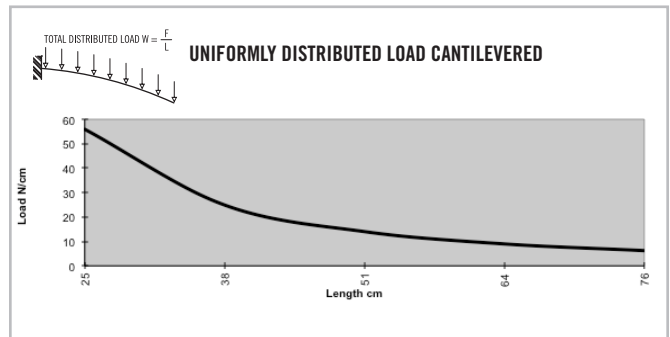
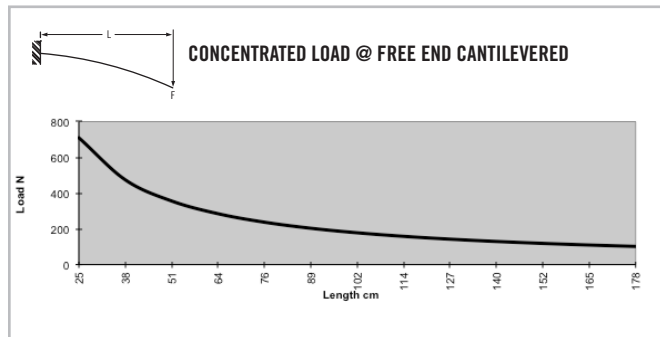
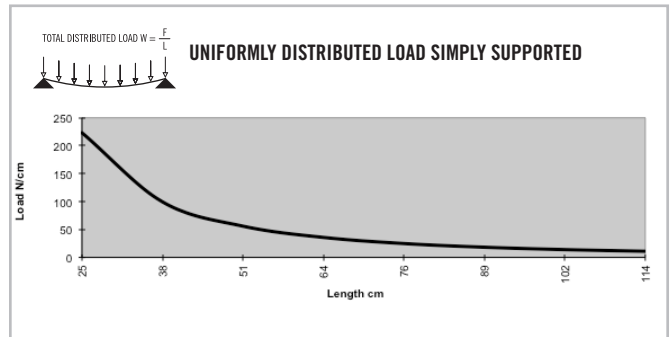
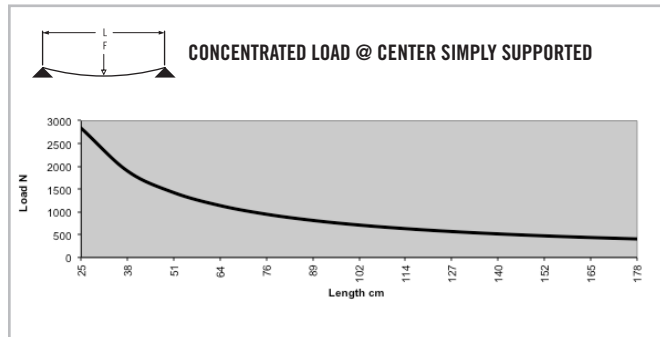

* Charts based on allowable loads related to yield strength with a margin of safety equal to five.

» For deflection equations see page 10

TS40-80LB

Clear Anodized - 670075

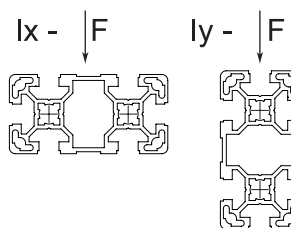
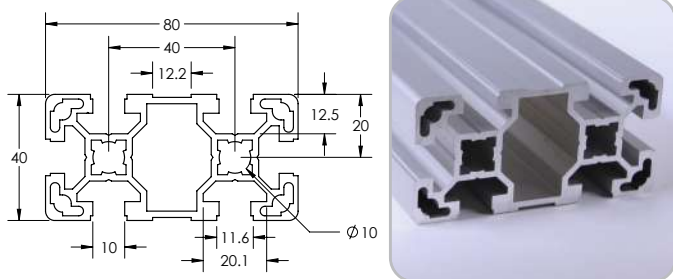

SPECIFICATIONS

Length	239" (6.07 m)
Weight	1.801 lbs/ft (2.680 kg/m)
Estimated Area	1.501 in ² (9.684 cm ²)
Moment of Inertia	I _x =0.412 in ⁴ (17.149 cm ⁴)
	I _y =1.499 in ⁴ (62.393 cm ⁴)

MACHINE SERVICES

CTL	660006
Access Hole 9.8mm	670520
Access Hole 17mm	670521
Tap M12	670514

BEAM SELECTION BY LOAD AND LENGTH

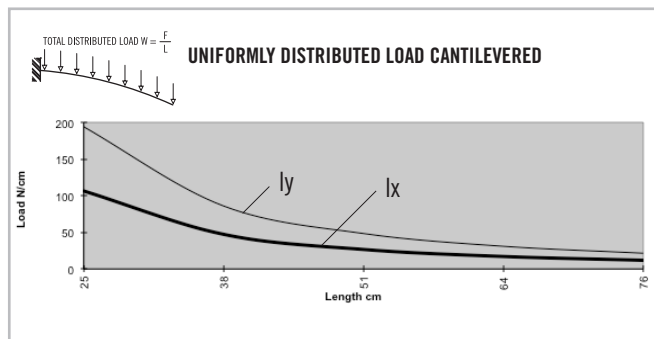
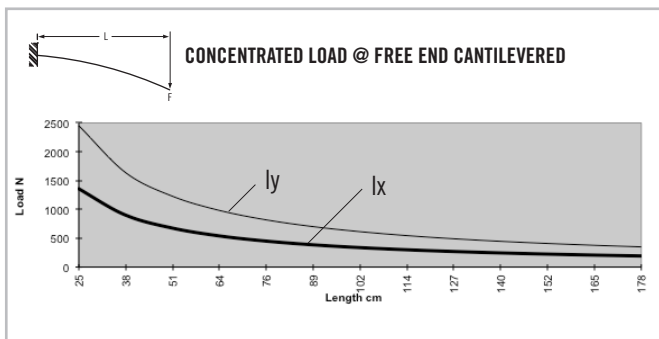
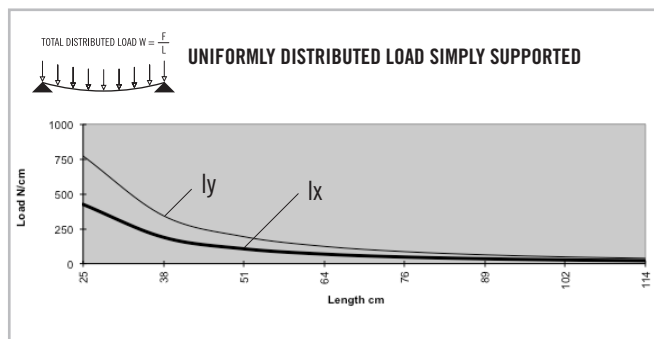
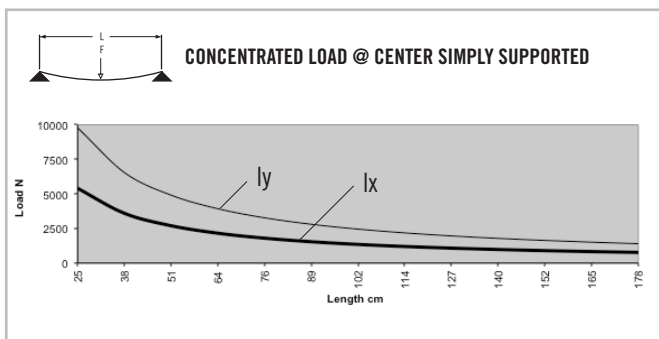

* Charts based on allowable loads related to yield strength with a margin of safety equal to five.

» For deflection equations see page 10

B-Series Extrusions

TS80-80LB

Clear Anodized - 670077

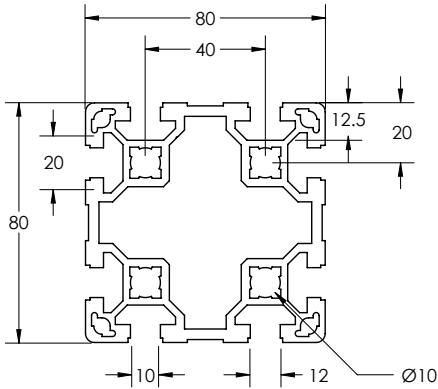

SPECIFICATIONS

Length	239" (6.07 m)
Weight	3.376 lbs/ft (4.911 kg/m)
Estimated Area	2.813 in ² (18.148 cm ²)
Moment of Inertia	$I_x=3.172 \text{ in}^4$ (132.028 cm ⁴) $I_y=3.172 \text{ in}^4$ (132.028 cm ⁴)

MACHINE SERVICES

CTL	660013
Access Hole 9.8mm	670520
Access Hole 17mm	670521
Tap M12	670515

BEAM SELECTION BY LOAD AND LENGTH

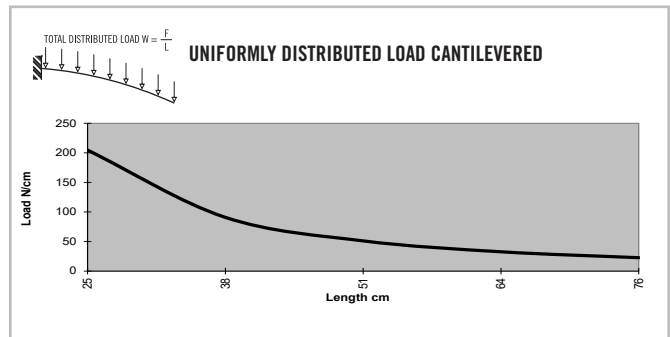
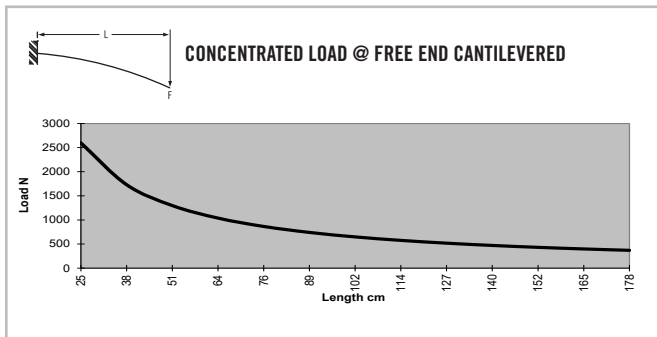
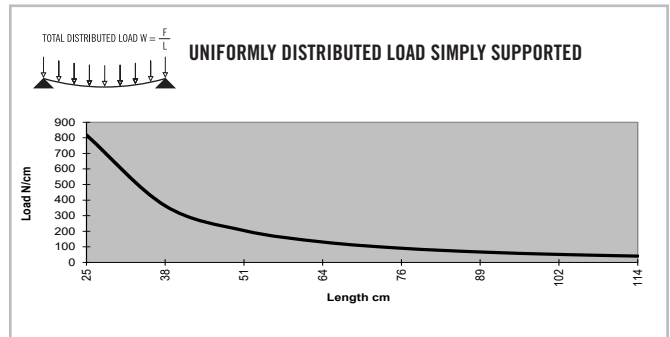
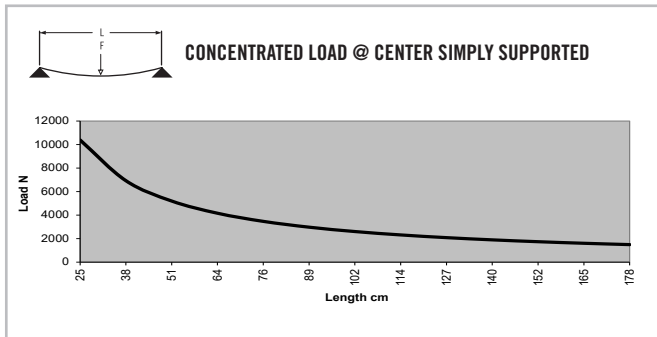

* Charts based on allowable loads related to yield strength with a margin of safety equal to five.

» For deflection equations see page 10

TS80-160LB

Clear Anodized - 670078

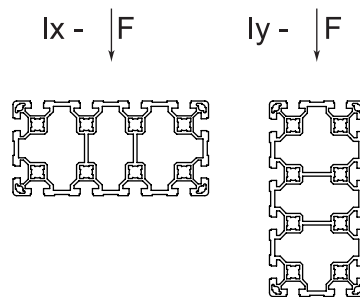
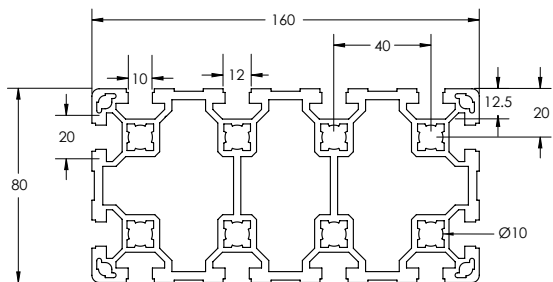

SPECIFICATIONS

Length	239" (6.07 m)
Weight	5.965 lbs/ft (8.780 kg/m)
Estimated Area	4.971 in ² (32.071 cm ²)
Moment of Inertia	$I_x=6.020 \text{ in}^4 (250.571 \text{ cm}^4)$
	$I_y=19.847 \text{ in}^4 (826.094 \text{ cm}^4)$

MACHINE SERVICES

CTL	660008
Access Hole 9.8mm	670520
Access Hole 17mm	670521
Tap M12	670528

BEAM SELECTION BY LOAD AND LENGTH

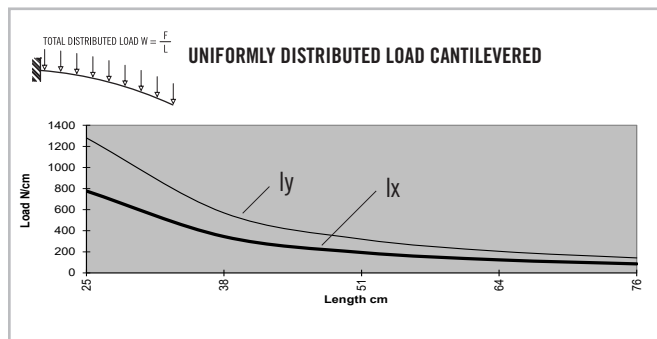
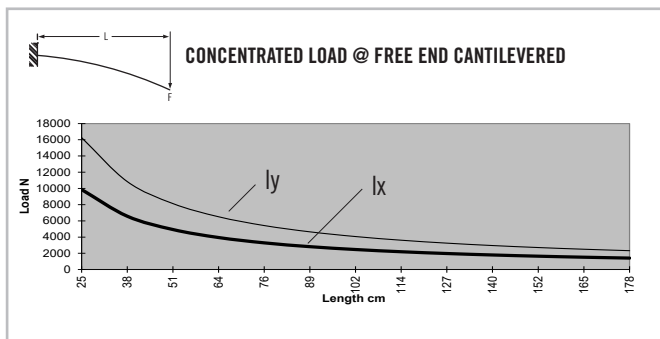
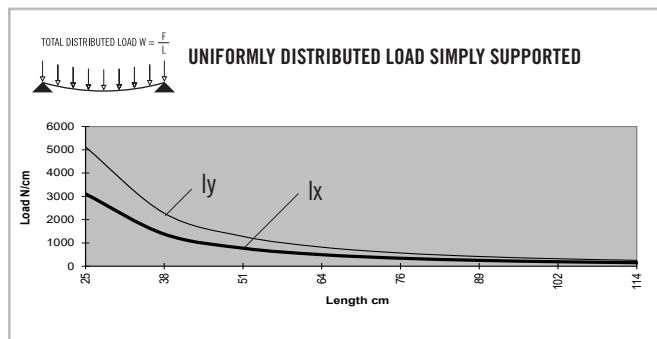
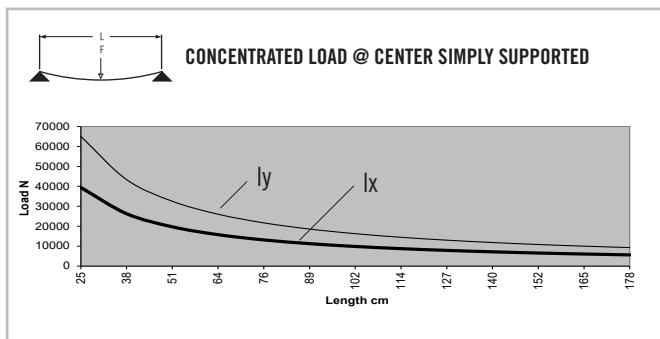

* Charts based on allowable loads related to yield strength with a margin of safety equal to five.

» For deflection equations see page 10

B-Series Extrusions

TS22.5-45B

Clear Anodized - 670067

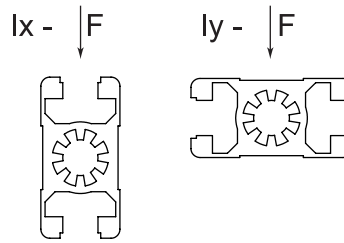
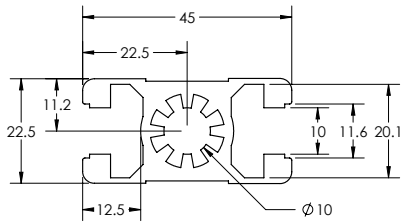

SPECIFICATIONS

Length	239" (6.07 m)
Weight	0.850 lbs/ft (1.264 kg/m)
Estimated Area	0.708 in ² (4.5666 cm ²)
Moment of Inertia	Ix=0.069 in ⁴ (2.87 cm ⁴) Iy=0.171 in ⁴ (7.12 cm ⁴)

MACHINE SERVICES

CTL	670502
Access Hole 7.9mm	670520
Access Hole 11mm	670521
Tap M12	670513

BEAM SELECTION BY LOAD AND LENGTH

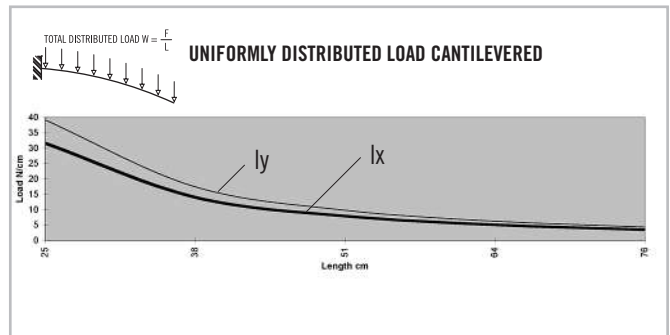
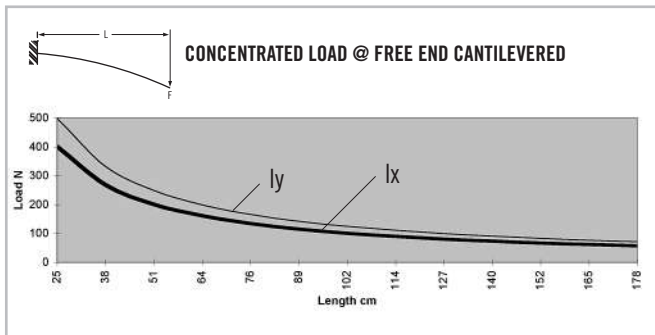
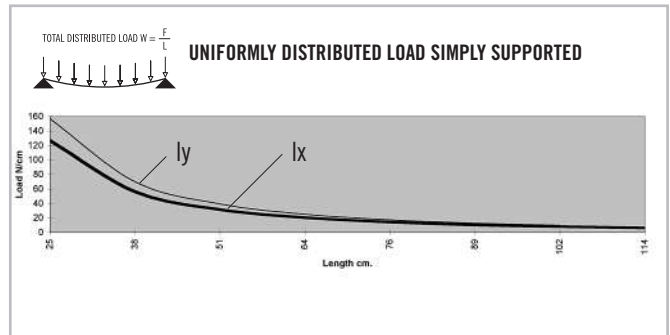
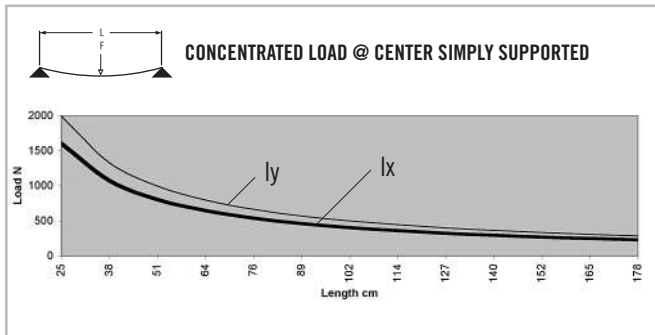

* Charts based on allowable loads related to yield strength with a margin of safety equal to five.

» For deflection equations see page 10

Clear Anodized - **670030**
 Black Anodized - **670130**
 Yellow Powdercoat - **670230**

TS45-45LB

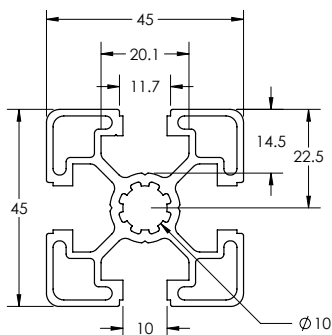

SPECIFICATIONS

Length Clear	239" (6.07 m)
Length Black	239" (6.07 m)
Length Yellow	144" (3.6 m)
Weight	1.064 lbs/ft (1.583 kg/m)
Estimated Area	0.884 in ² (5.7018 cm ²)
Moment of Inertia	$I_x=0.264 \text{ in}^4$ (10.99 cm ⁴)
	$I_y=0.264 \text{ in}^4$ (10.99 cm ⁴)

MACHINE SERVICES

CTL	670504
Access Hole 9.8mm	670520
Access Hole 17mm	670521
Tap M12	670513

BEAM SELECTION BY LOAD AND LENGTH

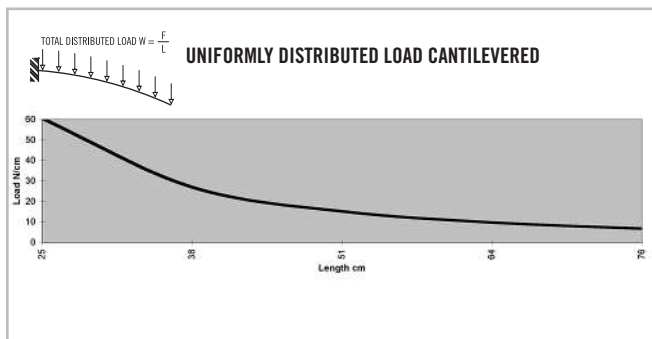
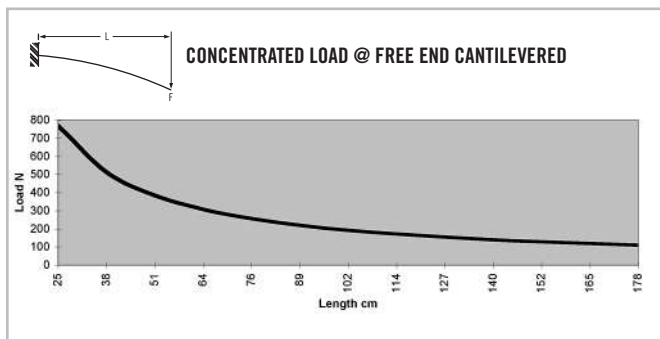
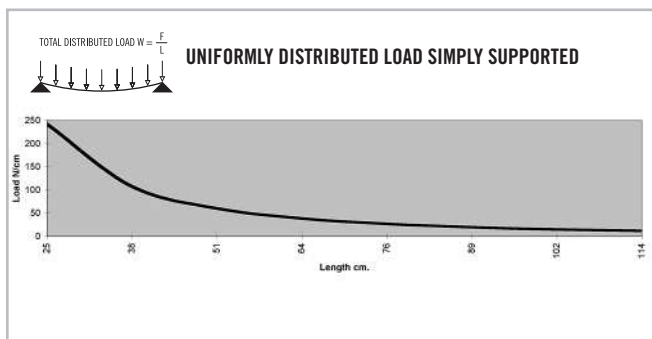
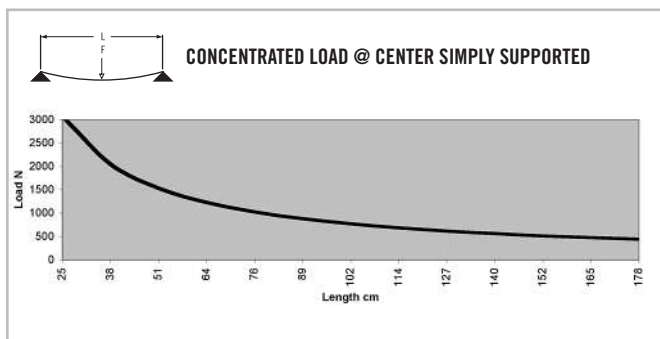

* Charts based on allowable loads related to yield strength with a margin of safety equal to five.

» For deflection equations see page 10

B-Series Extrusions

TS45-45HB

Clear Anodized - 670031

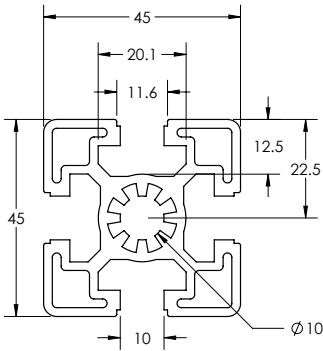

SPECIFICATIONS

Length	239" (6.07 m)
Weight	1.392 lbs/ft (2.071 kg/m)
Estimated Area	1.16 in ² (7.482 cm ²)
Moment of Inertia	$I_x=0.334$ in ⁴ (13.90 cm ⁴) $I_y=0.334$ in ⁴ (13.90 cm ⁴)

MACHINE SERVICES

CTL	670504
Access Hole 9.8mm	670520
Access Hole 17mm	670521
Tap M12	670513

BEAM SELECTION BY LOAD AND LENGTH

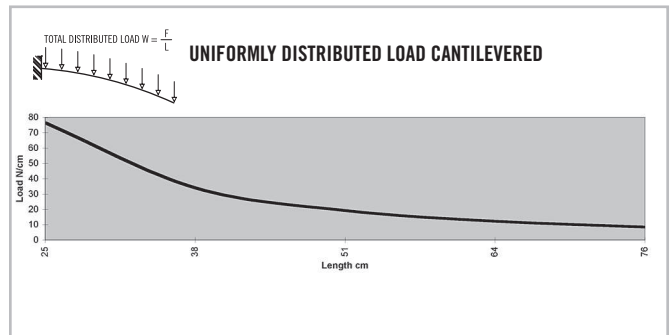
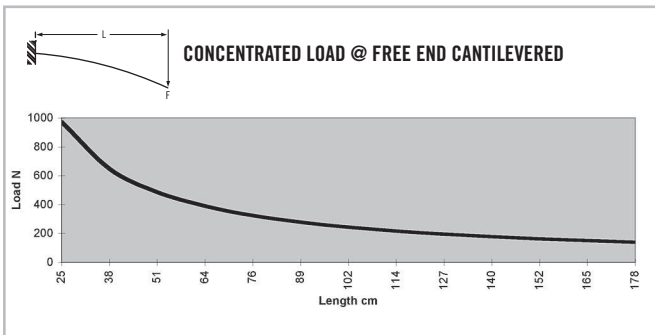
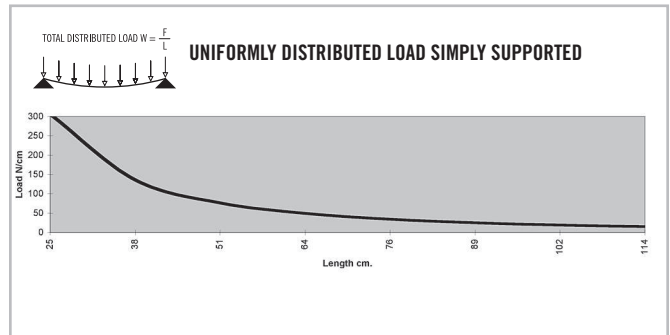
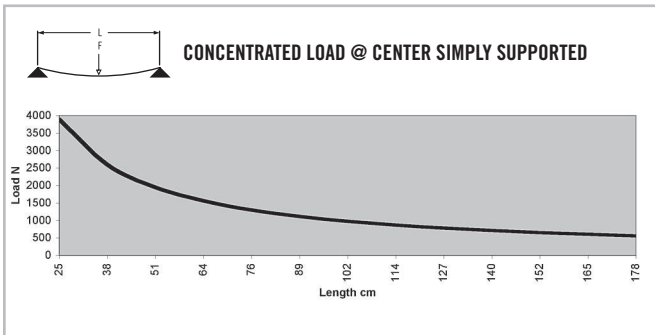

* Charts based on allowable loads related to yield strength with a margin of safety equal to five.

» For deflection equations see page 10

TS45-45LB MONOSLOT

Clear Anodized - 670083

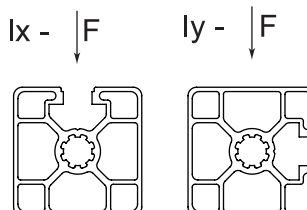
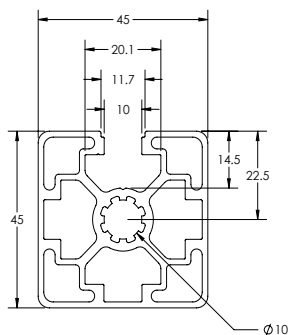

SPECIFICATIONS

Length	239" (6.07 m)
Weight	1.042 lbs/ft (1.551 kg/m)
Estimated Area	0.868 in ² (5.600 kg/m)
Moment of Inertia	I _x =0.266 in ⁴ (11.072 cm ²)
	I _y =0.269 in ⁴ (11.197 cm ²)

MACHINE SERVICES

CTL	670504
Access Hole 9.8mm	670520
Access Hole 17mm	670521
Tap M12	670513

BEAM SELECTION BY LOAD AND LENGTH

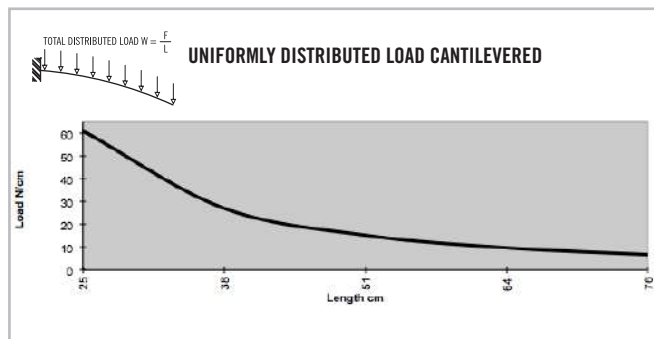
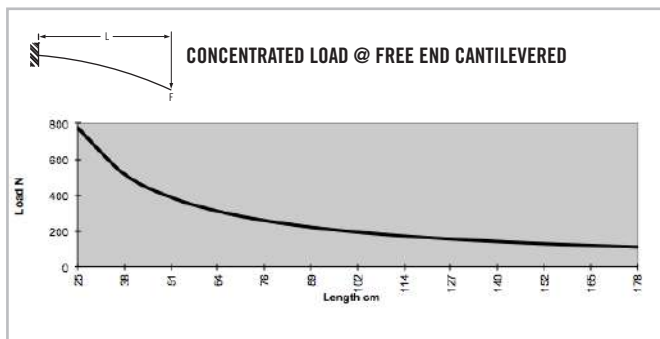
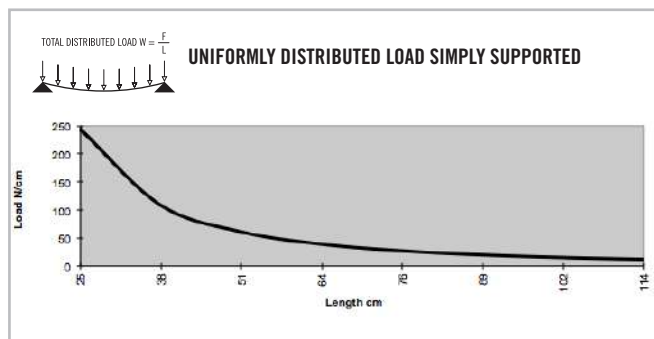
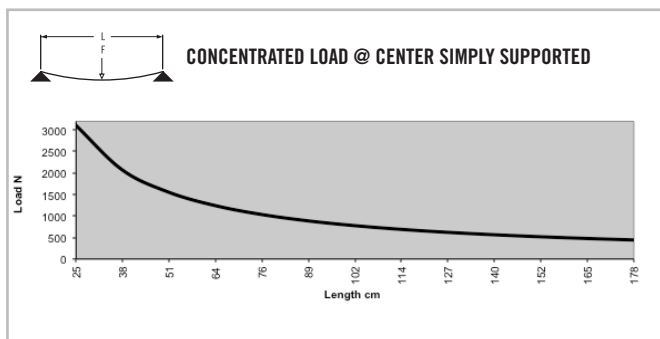

* Charts based on allowable loads related to yield strength with a margin of safety equal to five.

» For deflection equations see page 10

B-Series Extrusions

TS45-45LB BISLOT ADJ

Clear Anodized - 670081

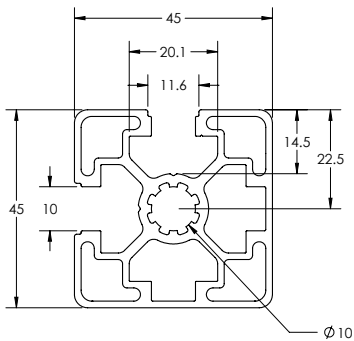

SPECIFICATIONS

Length	239" (6.07 m)
Weight	1.045 lbs/ft (1.555 kg/m)
Estimated Area	0.871 in ² (5.619 cm ²)
Moment of Inertia	I _x =0.266 in ⁴ (11.072 cm ²)
	I _y =0.266 in ⁴ (11.072 cm ²)

MACHINE SERVICES

CTL	670504
Access Hole 9.8mm	670520
Access Hole 17mm	670521
Tap M12	670513

BEAM SELECTION BY LOAD AND LENGTH

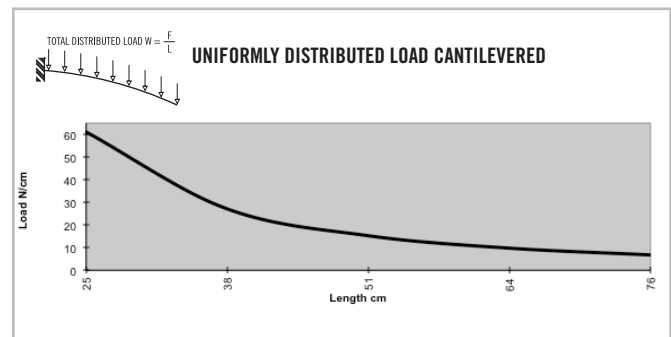
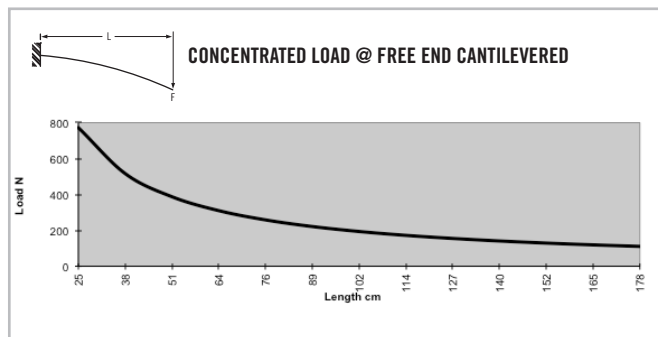
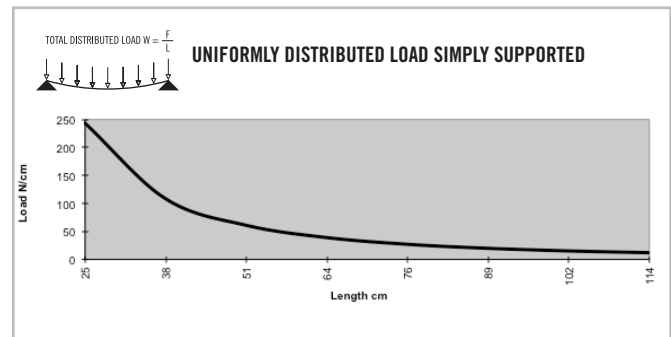
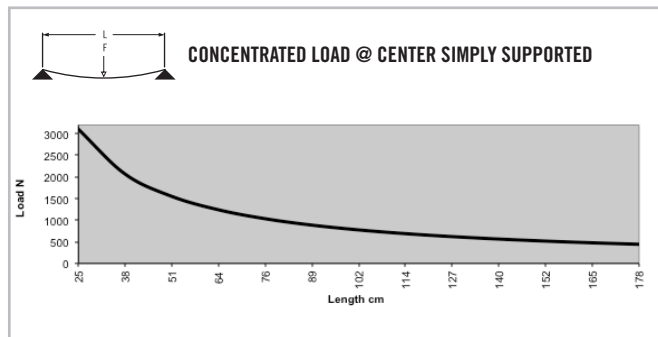

* Charts based on allowable loads related to yield strength with a margin of safety equal to five.

» For deflection equations see page 10

TS45-45LB BISLOT OPP

Clear Anodized - 670080

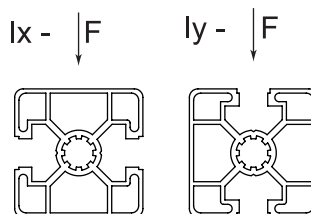
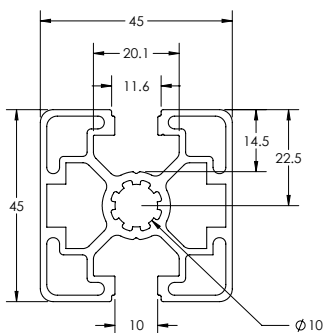

SPECIFICATIONS

Length	239" (6.07 m)
Weight	1.045 lbs/ft (1.555 kg/m)
Estimated Area	0.871 in ² (5.619 cm ²)
Moment of Inertia	$I_x=0.263 \text{ in}^4$ (10.947 cm ²)
	$I_y=0.270 \text{ in}^4$ (11.238 cm ²)

MACHINE SERVICES

CTL	670504
Access Hole 9.8mm	670520
Access Hole 17mm	670521
Tap M12	670513

BEAM SELECTION BY LOAD AND LENGTH

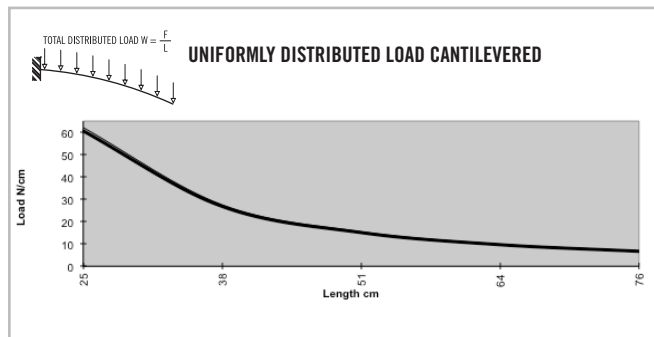
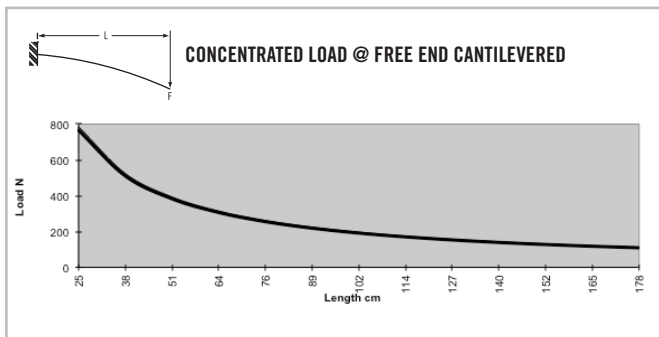
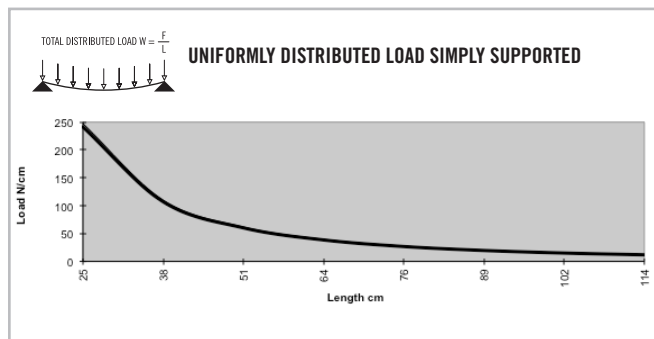
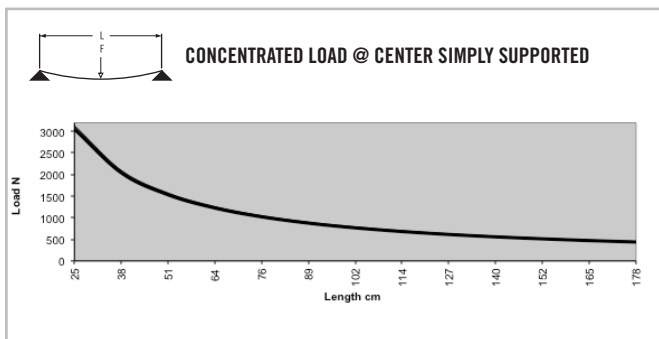

* Charts based on allowable loads related to yield strength with a margin of safety equal to five.

» For deflection equations see page 10

B-Series Extrusions

TS45-45LB TRISLOT

Clear Anodized - 670082

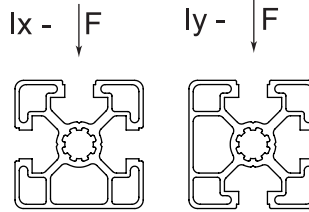
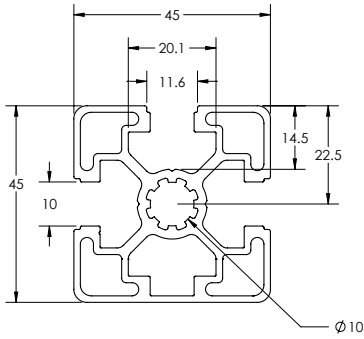

SPECIFICATIONS

Length	239" (6.07 m)
Weight	1.063 lbs/ft (1.583 kg/m)
Estimated Area	0.886 in ² (5.716 cm ²)
Moment of Inertia	I _x =0.265 in ⁴ (11.030 cm ⁴)
	I _y =0.268 in ⁴ (11.155 cm ⁴)

MACHINE SERVICES

CTL	670504
Access Hole 9.8mm	670520
Access Hole 17mm	670521
Tap M12	670513

BEAM SELECTION BY LOAD AND LENGTH

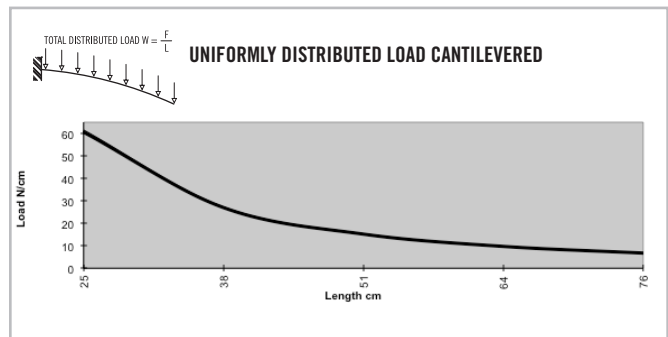
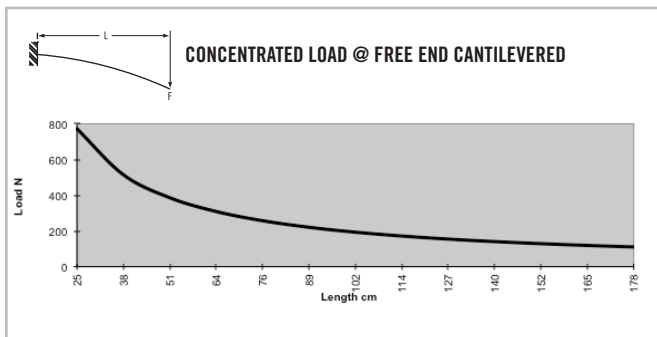
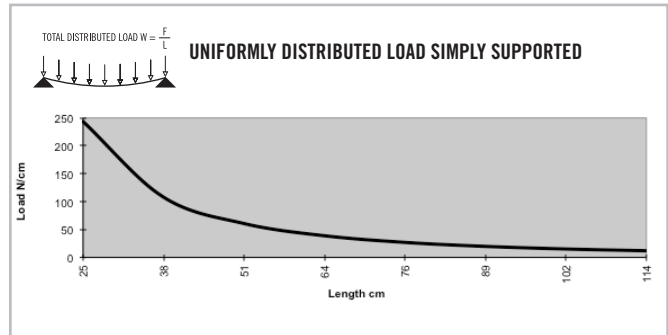
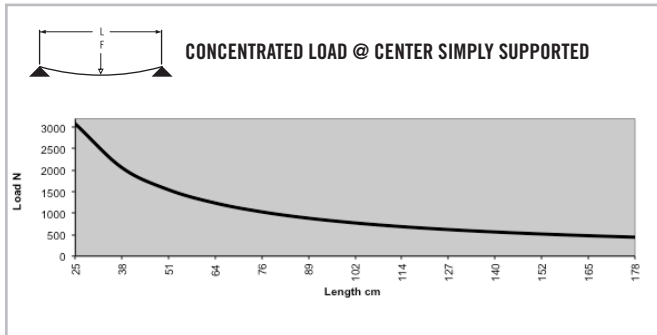

* Charts based on allowable loads related to yield strength with a margin of safety equal to five.

» For deflection equations see page 10

TS45-45LRB

Clear Anodized - 670037

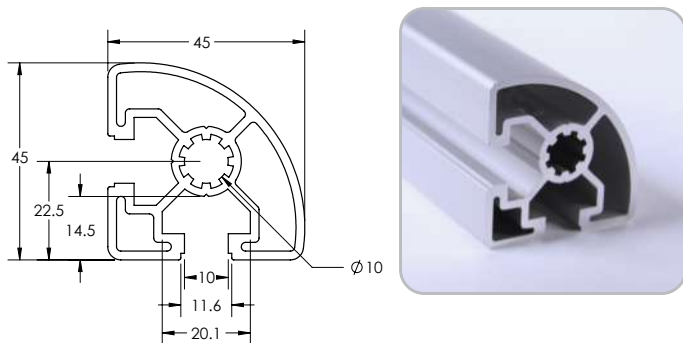

SPECIFICATIONS

Length	239" (6.07 m)
Weight	1.004 lbs/ft (1.495 kg/m)
Estimated Area	0.837 in ² (5.399 cm ²)
Moment of Inertia	$I_x=0.214 \text{ in}^4$ (8.91 cm ⁴)
		$I_y=0.214 \text{ in}^4$ (8.91 cm ⁴)

MACHINE SERVICES

CTL	670504
Access Hole 9.8mm	670520
Access Hole 17mm	670521
Tap M12	670513

BEAM SELECTION BY LOAD AND LENGTH

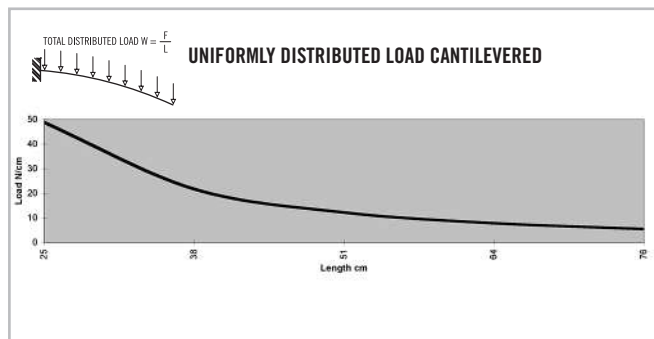
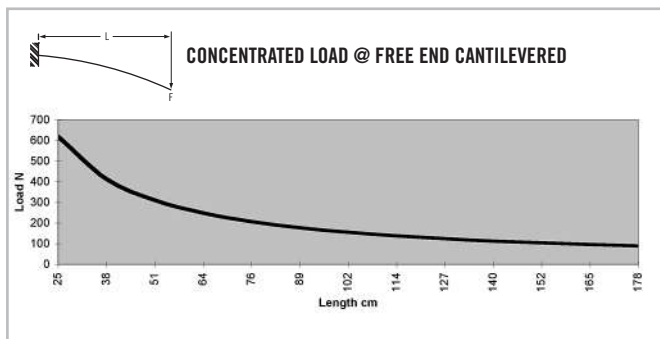
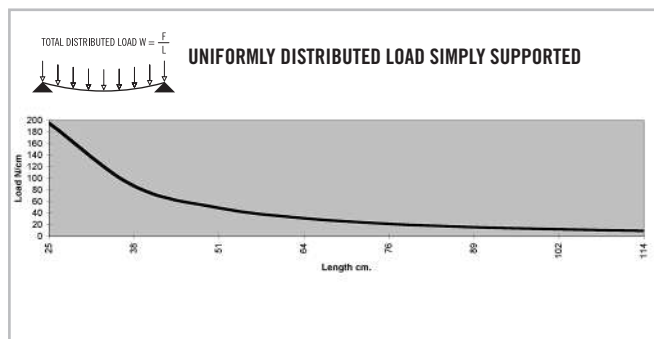
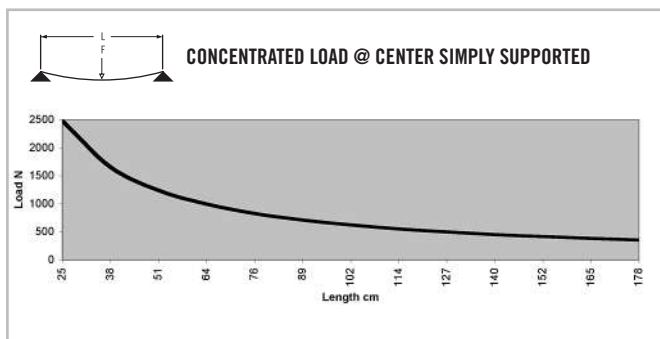

* Charts based on allowable loads related to yield strength with a margin of safety equal to five.

» For deflection equations see page 10

B-Series Extrusions

TS45-45B HR

Clear Anodized - 670032

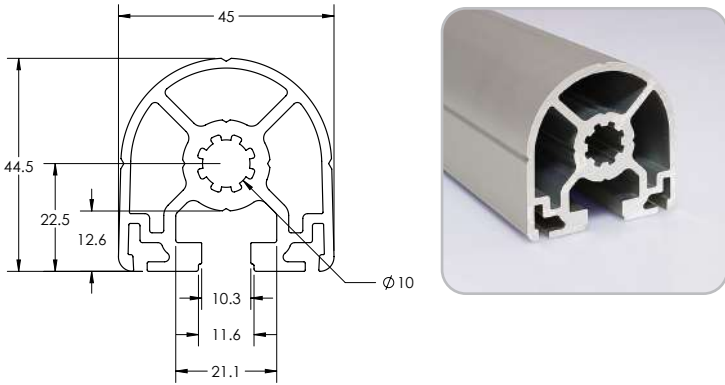

SPECIFICATIONS

Length	239" (6.07 m)
Weight	1.248 lbs/ft (1.857 kg/m)
Estimated Area	1.042. in ² (6.722 cm ²)
Moment of Inertia	0.216 I _x = in ⁴ (8.99 cm ⁴) 0.212 I _y = in ⁴ (8.82 cm ⁴)

MACHINE SERVICES

CTL	670504
Access Hole 9.8mm	670520
Access Hole 17mm	670521
Tap M12	670513

BEAM SELECTION BY LOAD AND LENGTH

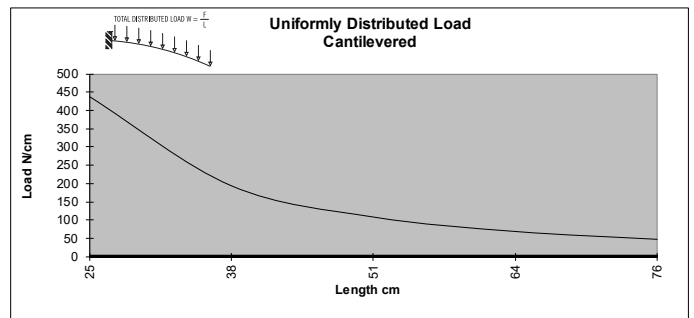
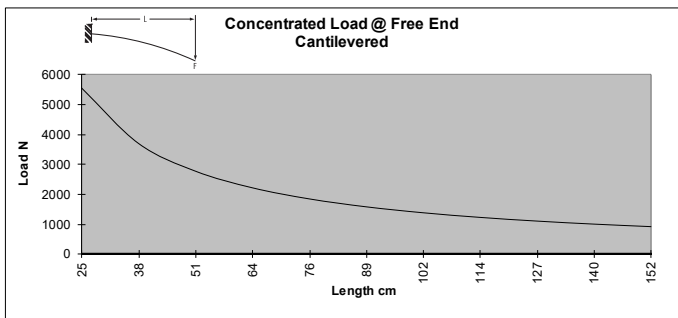
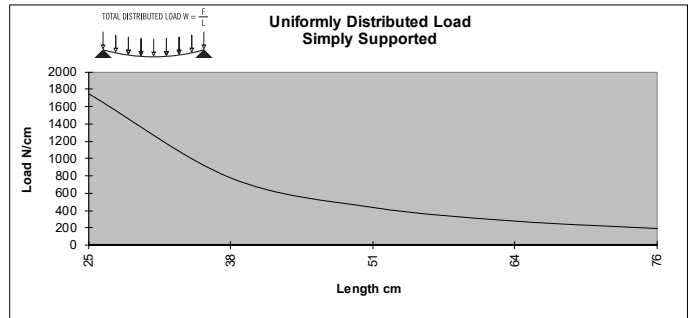
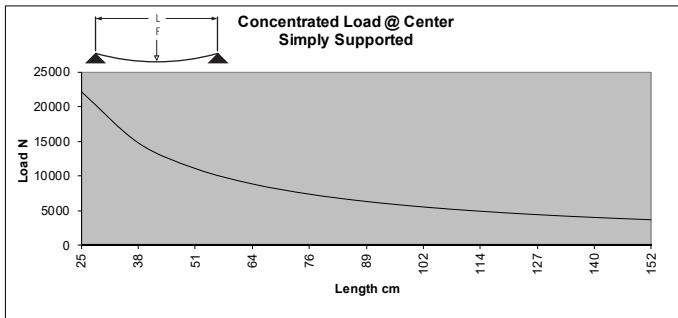

* Charts based on allowable loads related to yield strength with a margin of safety equal to five.

» For deflection equations see page 10

TS45-90LB

Clear Anodized - 670043
Black Anodized - 670143

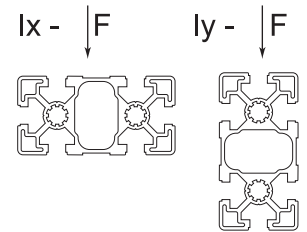
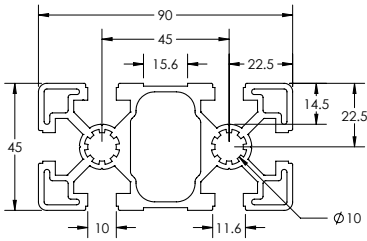

SPECIFICATIONS

Length	239" (6.07 m)
Weight	2.365 lbs/ft (3.520 kg/m)
Estimated Area	1.973 in ² (12.72585 cm ²)
Moment of Inertia	$I_x=0.644 \text{ in}^4 (26.81 \text{ cm}^4)$ $I_y=2.349 \text{ in}^4 (97.77 \text{ cm}^4)$

MACHINE SERVICES

CTL	670505
Access Hole 9.8mm	670520
Access Hole 17mm	670521
Tap M12	670514

BEAM SELECTION BY LOAD AND LENGTH

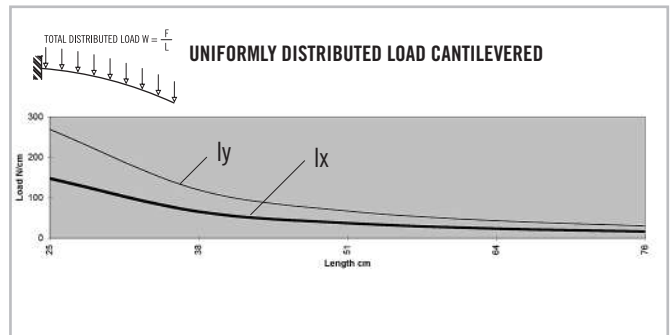
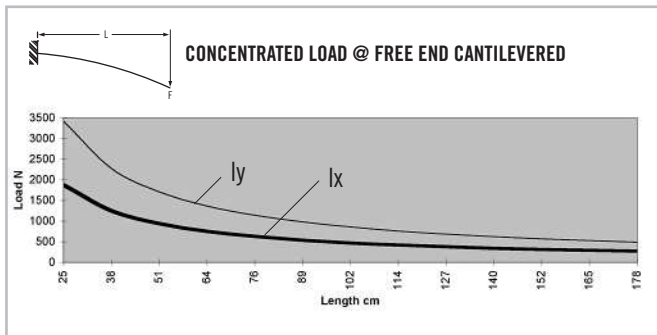
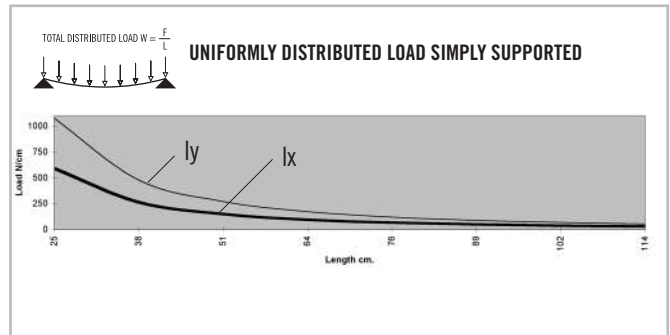
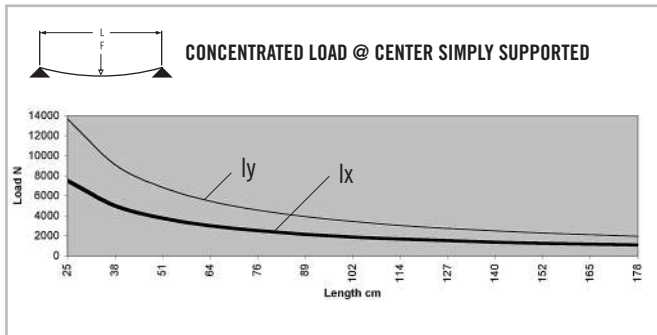

* Charts based on allowable loads related to yield strength with a margin of safety equal to five.

» For deflection equations see page 10

B-Series Extrusions

TS45-90HB

Clear Anodized - 670044

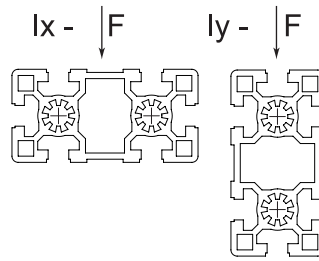
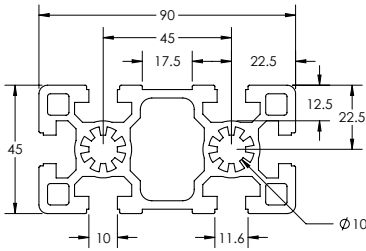

SPECIFICATIONS

Length	239" (6.07 m)
Weight	2.832 lbs/ft (4.216 kg/m)
Estimated Area	2.36 in ² (15.226 cm ²)
Moment of Inertia	lx=0.774 in ⁴ (32.21 cm ⁴)
	ly=2.978 in ⁴ (123.94 cm ⁴)

MACHINE SERVICES

CTL	670505
Access Hole 9.8mm	670520
Access Hole 17mm	670521
Tap M12	670514

BEAM SELECTION BY LOAD AND LENGTH

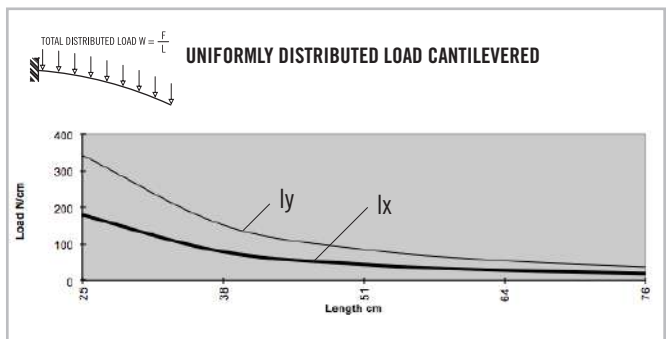
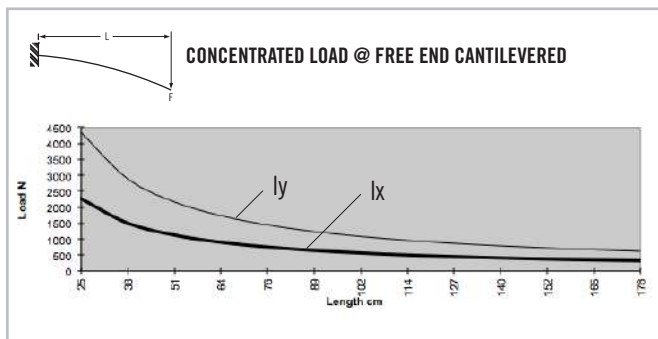
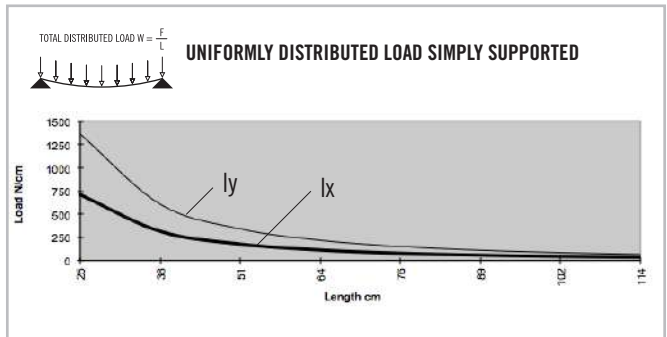
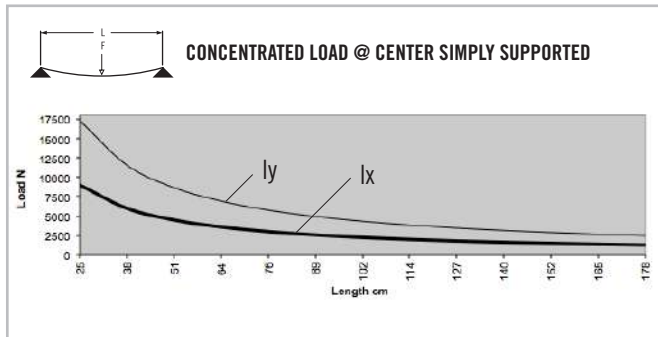

* Charts based on allowable loads related to yield strength with a margin of safety equal to five.

» For deflection equations see page 10

TS60-60LB 4 SLOT

Clear Anodized - 670051

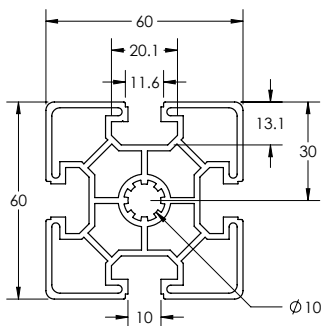

SPECIFICATIONS

Length	239" (6.07 m)
Weight	1.732 lbs/ft (2.578 kg/m)
Estimated Area	1.444 in ² (9.3138 cm ²)
Moment of Inertia	$I_x=0.76 \text{ in}^4$ (31.63 cm ⁴) $I_y=0.76 \text{ in}^4$ (31.63 cm ⁴)

MACHINE SERVICES

CTL	670506
Access Hole 9.8mm	670520
Access Hole 17mm	670521
Tap M12	670513

BEAM SELECTION BY LOAD AND LENGTH

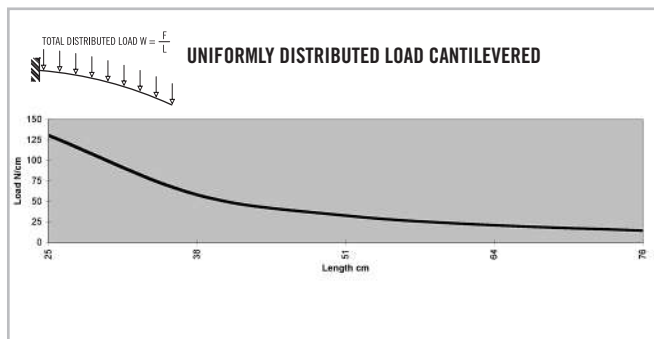
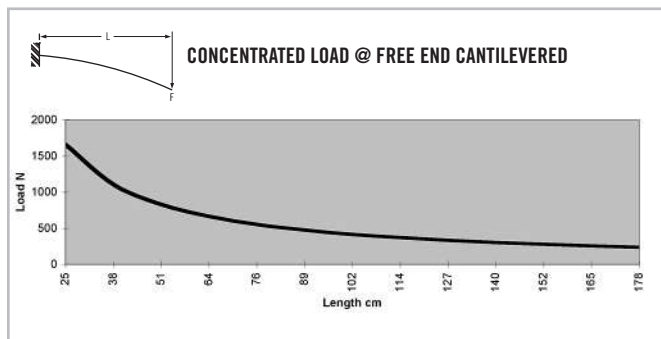
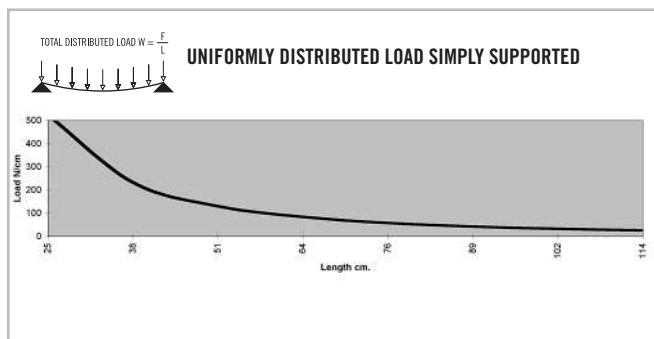
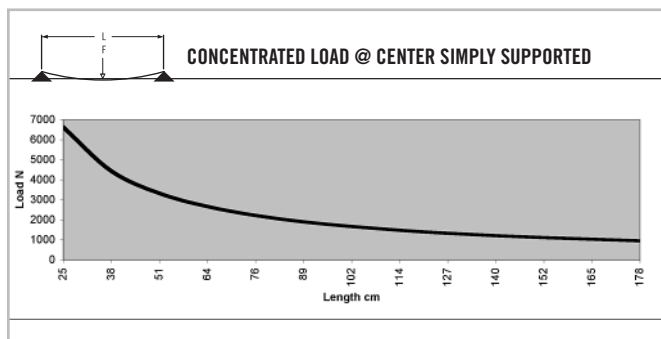

* Charts based on allowable loads related to yield strength with a margin of safety equal to five.

» For deflection equations see page 10

B-Series Extrusions

TS60-60HB 4 SLOT

Clear Anodized - 670052

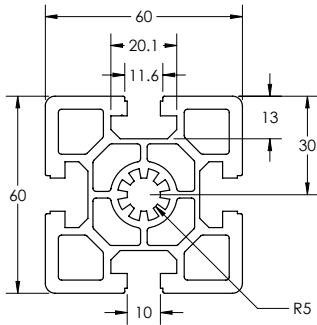

SPECIFICATIONS

Length	239" (6.07 m)
Weight	2.671 lbs/ft (3.975 kg/m)
Estimated Area	2.226 in ² (14.361 cm ²)
Moment of Inertia	I _x =1.264 in ⁴ (52.612 cm ⁴)
	I _y =1.264 in ⁴ (52.612 cm ⁴)

MACHINE SERVICES

CTL	670506
Access Hole 9.8mm	670520
Access Hole 17mm	670521
Tap M12	670513

BEAM SELECTION BY LOAD AND LENGTH

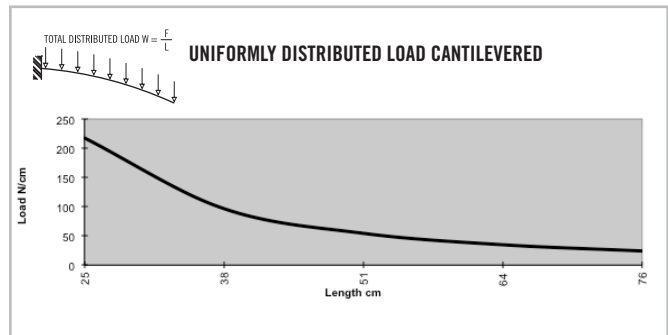
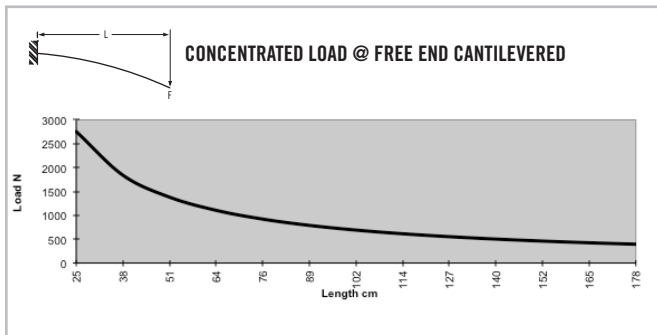
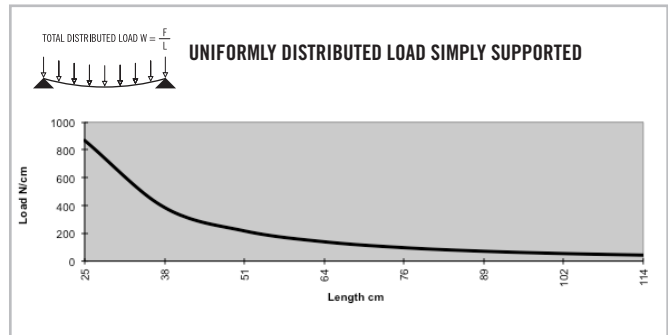
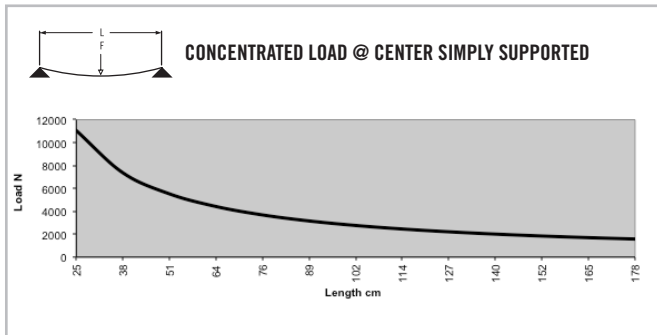

* Charts based on allowable loads related to yield strength with a margin of safety equal to five.

» For deflection equations see page 10

TS60-60B 8 SLOT

Clear Anodized - **670018**

Black Anodized - **670118**

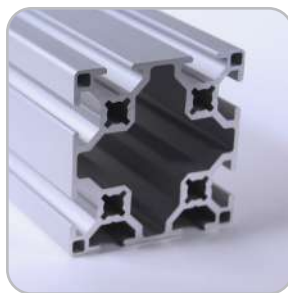
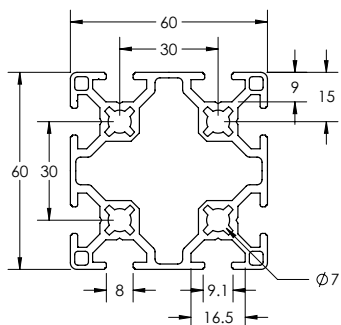

SPECIFICATIONS

Length	239" (6.07 m)
Weight	1.711 lbs/ft (2.546 kg/m)
Estimated Area	1.426 in ² (14.361 cm ²)
Moment of Inertia	$I_x=0.873 \text{ in}^4$ (36.337 cm ⁴)
	$I_y=0.873 \text{ in}^4$ (36.337 cm ⁴)

MACHINE SERVICES

CTL	670506
Access Hole 9.8mm	670520
Access Hole 17mm	670521
Tap M8	660032

BEAM SELECTION BY LOAD AND LENGTH

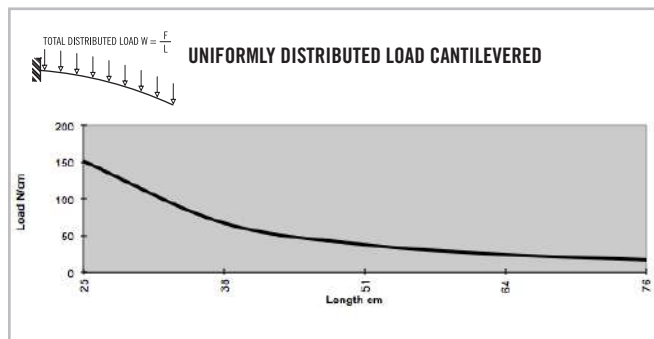
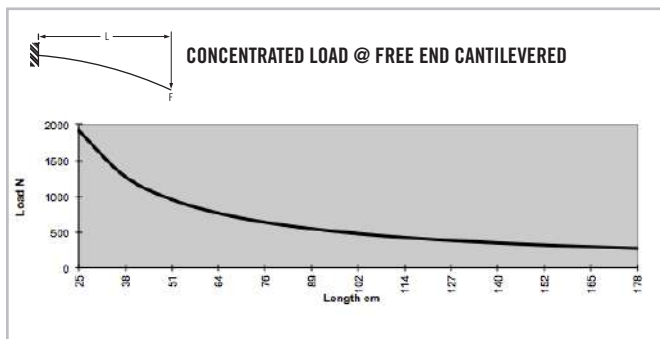
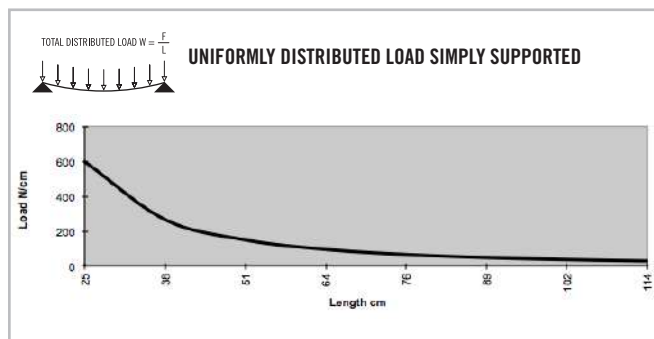
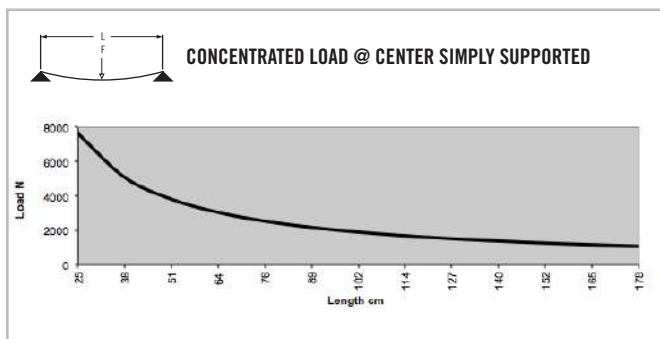

* Charts based on allowable loads related to yield strength with a margin of safety equal to five.

» For deflection equations see page 10

B-Series Extrusions

TS45-60HB

Clear Anodized - 670050

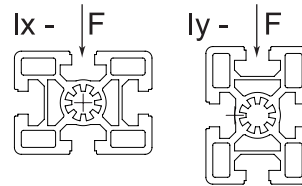
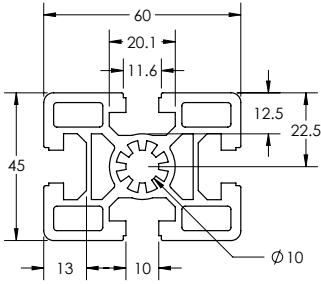

SPECIFICATIONS

Length	239" (6.07 m)
Weight	2.039 lbs/ft (3.034 kg/m)
Estimated Area	1.699 in ² (10.961 cm ²)
Moment of Inertia	I _x =0.544 in ⁴ (22.643 cm ⁴)
	I _y =0.894 in ⁴ (37.211 cm ⁴)

MACHINE SERVICES

CTL	670505
Access Hole 9.8mm	670520
Access Hole 17mm	670521
Tap M12	670513

BEAM SELECTION BY LOAD AND LENGTH

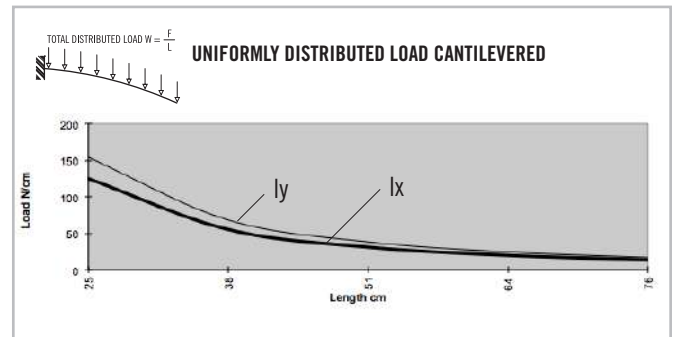
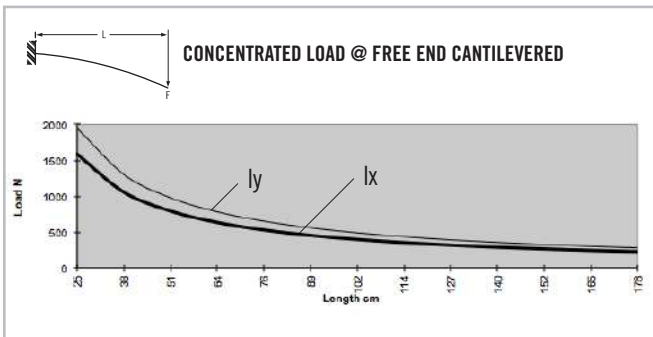
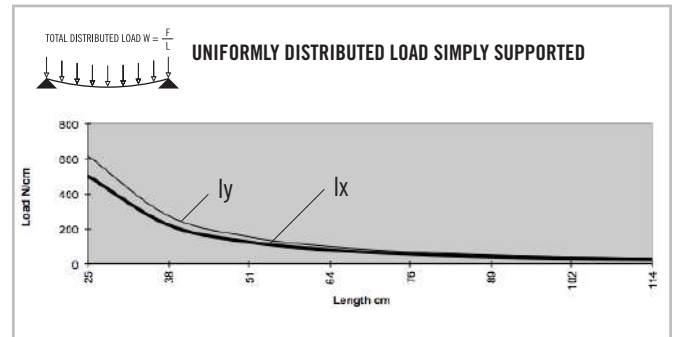
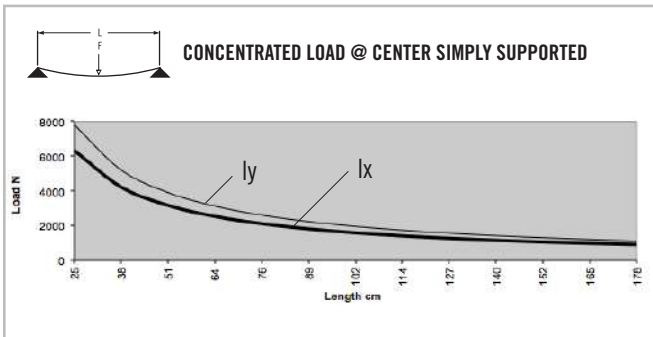

* Charts based on allowable loads related to yield strength with a margin of safety equal to five.

» For deflection equations see page 10

TS60-90HB

Clear Anodized - 670053

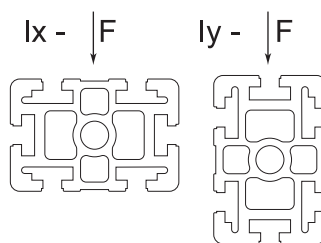
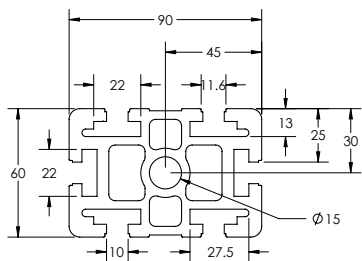

SPECIFICATIONS

Length	239" (6.07 m)
Weight	4.763 lbs/ft (7.088 kg/m)
Estimated Area	3.975 in ² (25.63875 cm ²)
Moment of Inertia	lx=2.173 in ⁴ (90.45 cm ⁴) ly=5.105 in ⁴ (212.49 cm ⁴)

MACHINE SERVICES

CTL	670507
Access Hole 9.8mm	670520
Access Hole 17mm	670521
Tap M16	670516

BEAM SELECTION BY LOAD AND LENGTH

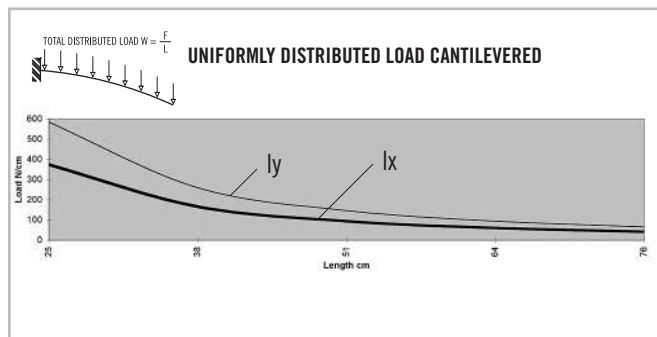
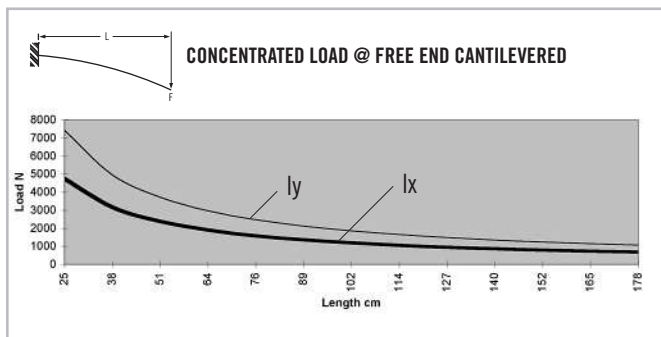
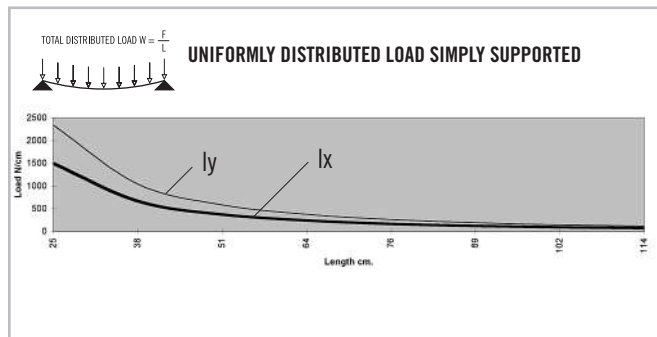
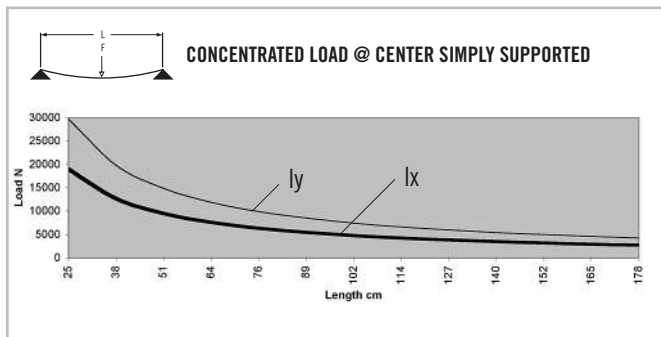

* Charts based on allowable loads related to yield strength with a margin of safety equal to five.

» For deflection equations see page 10

B-Series Extrusions

TS90-90LB

Clear Anodized - **670057**
 Black Anodized - **670157**

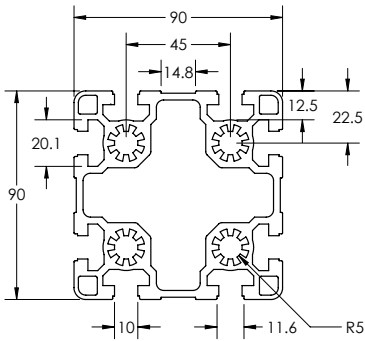

SPECIFICATIONS

Length	239" (6.07 m)
Weight	4.530 lbs/ft (6.741 kg/m)
Estimated Area	3.567 in ² (23.00715 cm ²)
Moment of Inertia	I _x =5.016 in ⁴ (208.78 cm ⁴) I _y =5.016 in ⁴ (208.78 cm ⁴)

MACHINE SERVICES

CTL	670508
Access Hole 9.8mm	670520
Access Hole 17mm	670521
Tap M12	670515

BEAM SELECTION BY LOAD AND LENGTH

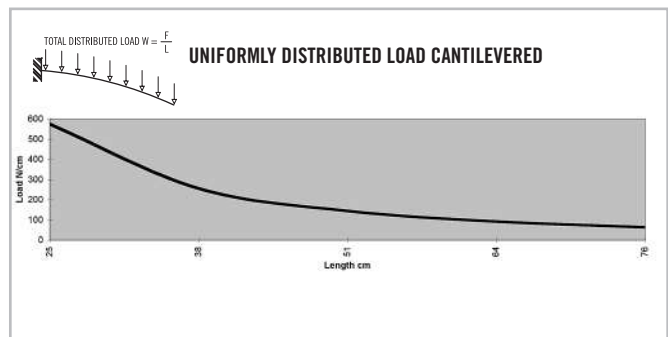
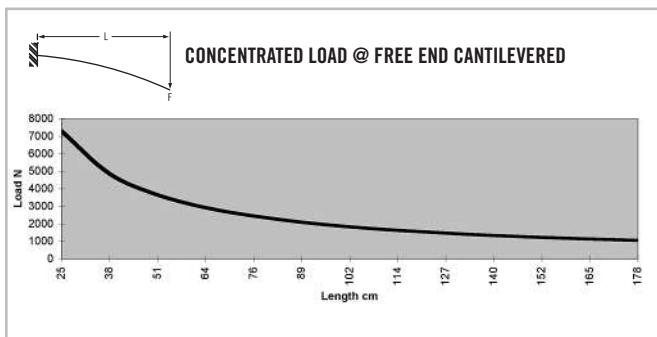
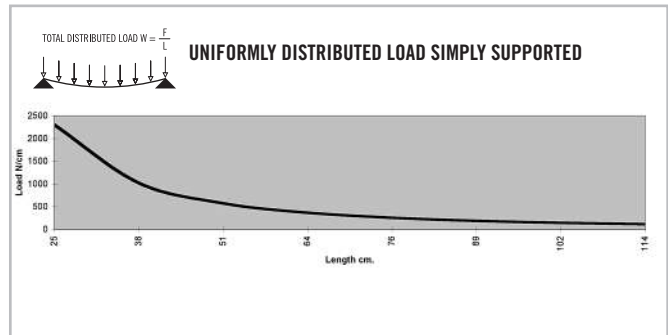
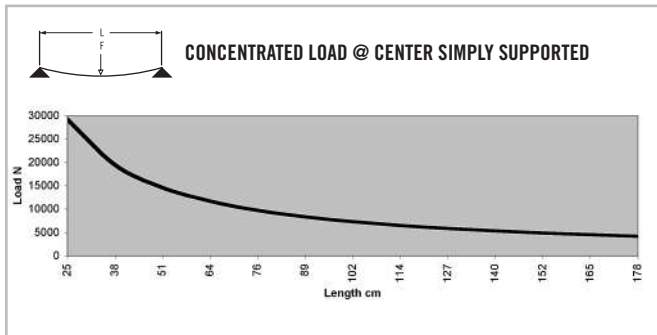

* Charts based on allowable loads related to yield strength with a margin of safety equal to five.

» For deflection equations see page 10

TS30-30FG 30B

Clear Anodized - 670070

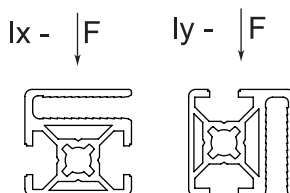
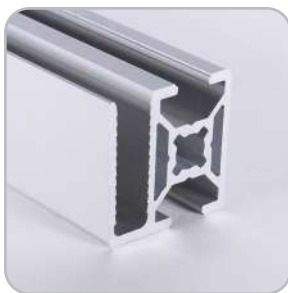
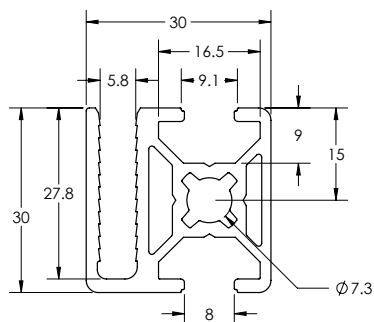

SPECIFICATIONS

Length	239" (6.07 m)
Weight	0.648 lbs/ft (0.964 kg/m)
Estimated Area	0.54 in ² (3.483 cm ²)
Moment of Inertia	I _x =0.065 in ⁴ (2.71 cm ⁴) I _y =0.08 in ⁴ (3.33 cm ⁴)

MACHINE SERVICES

CTL	670502
Access Hole 7.9mm	670518
Access Hole 11mm	670519
Tap M8	670511

BEAM SELECTION BY LOAD AND LENGTH

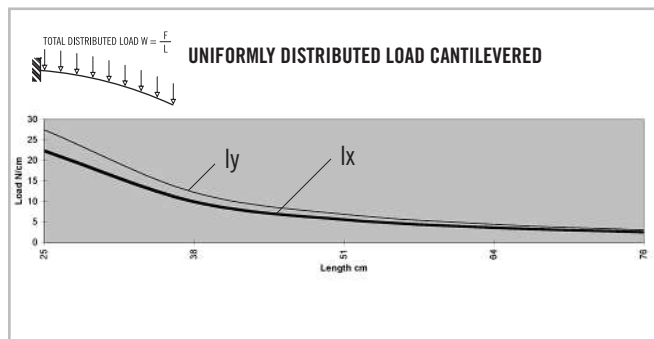
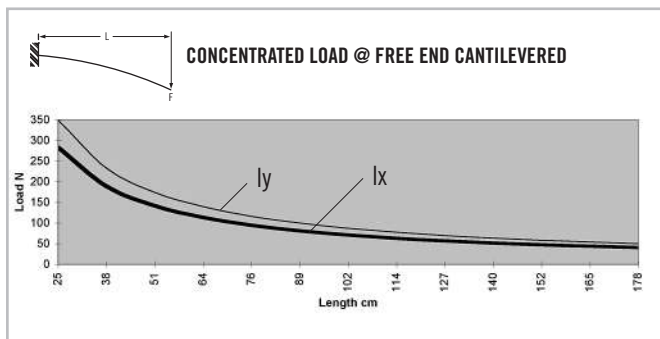
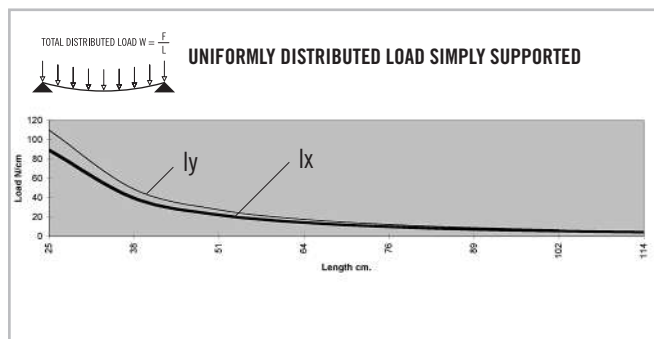
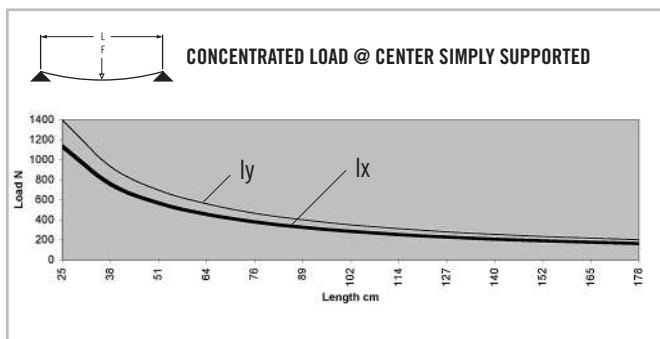

* Charts based on allowable loads related to yield strength with a margin of safety equal to five.

» For deflection equations see page 10

B-Series Extrusions

TS30-30FG 40B

Clear Anodized - 670072

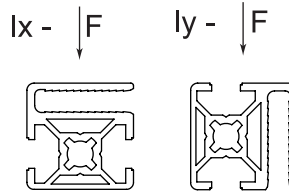
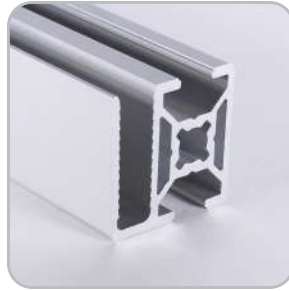
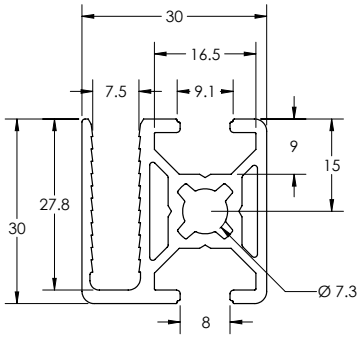

SPECIFICATIONS

Length	239" (6.07 m)
Weight	0.588 lbs/ft (0.875 kg/m)
Estimated Area	0.49 in ² (3.1605 cm ²)
Moment of Inertia	I _x =0.057 in ⁴ (2.37 cm ⁴) I _y =0.073 in ⁴ (3.04 cm ⁴)

MACHINE SERVICES

CTL	670502
Access Hole 7.9mm	670518
Access Hole 11mm	670519
Tap M8	670511

BEAM SELECTION BY LOAD AND LENGTH

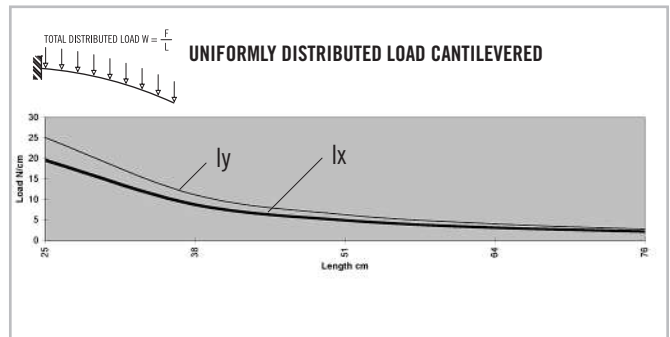
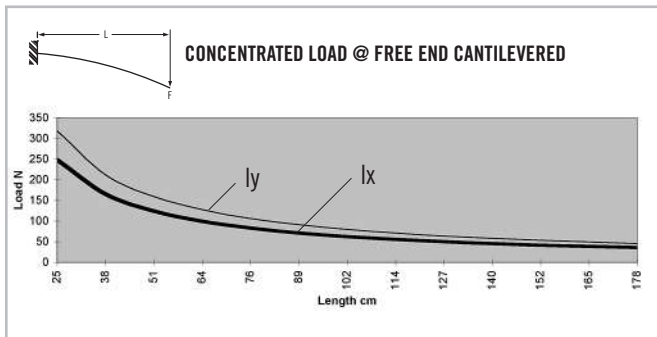
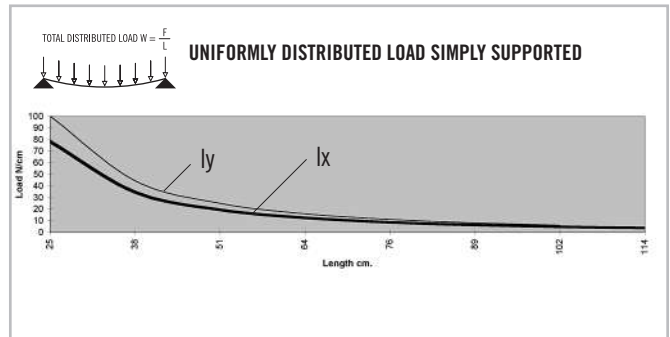
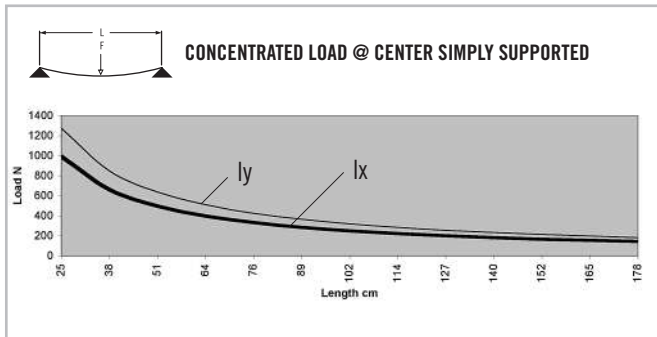

* Charts based on allowable loads related to yield strength with a margin of safety equal to five.

» For deflection equations see page 10

TS30-45FG30

Clear Anodized - 670071

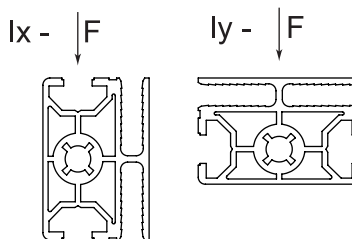
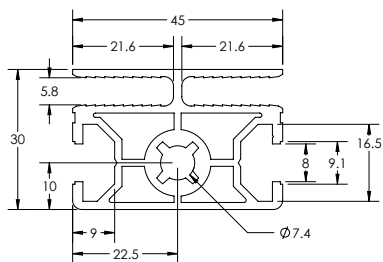

SPECIFICATIONS

Length	239" (6.07 m)
Weight	0.886 lbs/ft (1.289 kg/m)
Estimated Area	0.738 in ² (4.761 cm ²)
Moment of Inertia	lx=0.106 in ⁴ (4.412 cm ⁴)
	ly=0.184 in ⁴ (7.659 cm ⁴)

MACHINE SERVICES

CTL	670502
Access Hole 7.9mm	670518
Access Hole 11mm	670519
Tap M8	670511

BEAM SELECTION BY LOAD AND LENGTH

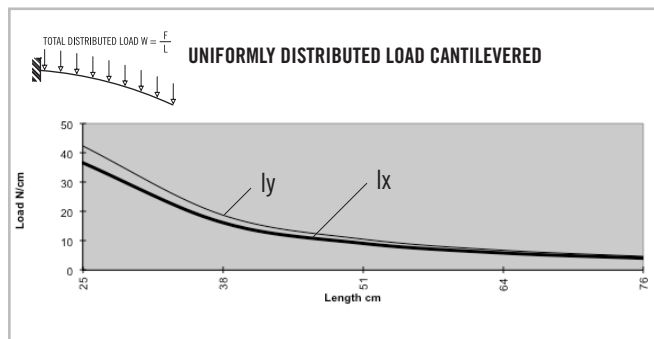
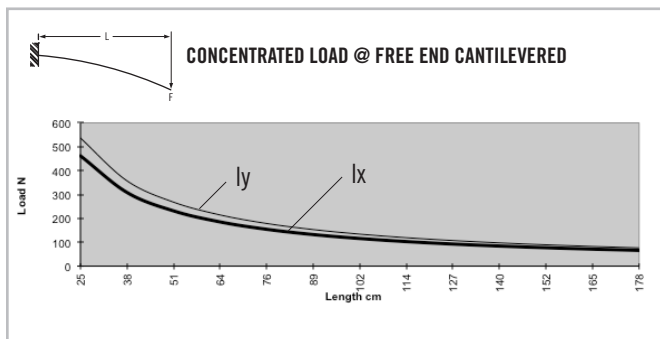
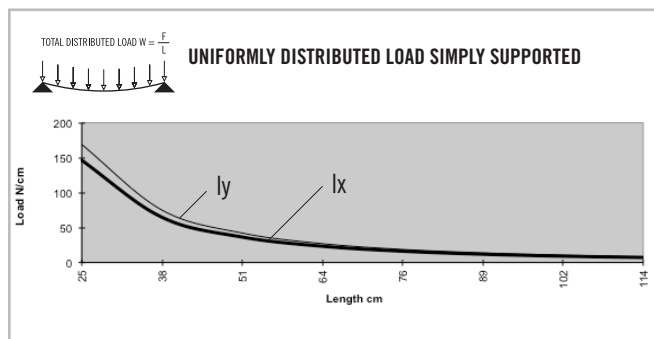
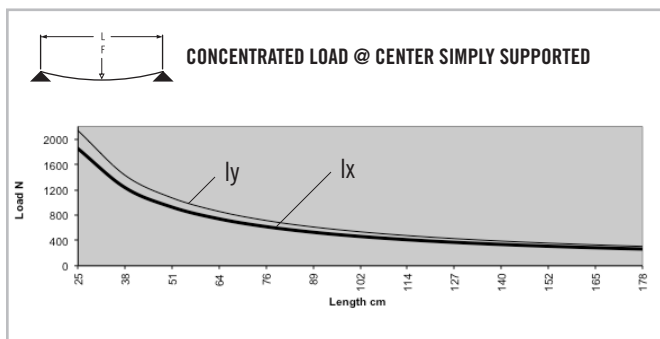

* Charts based on allowable loads related to yield strength with a margin of safety equal to five.

» For deflection equations see page 10

B-Series Extrusions

TS30-45FG40

Clear Anodized - 670074

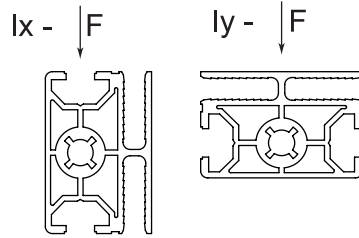
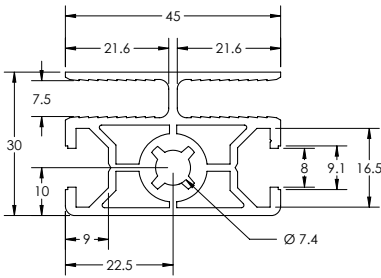

SPECIFICATIONS

Length	239" (6.07 m)
Weight	0.869 lbs/ft (1.293 kg/m)
Estimated Area	0.724 in ² (4.671 cm ²)
Moment of Inertia	$I_x=0.103 \text{ in}^4 (4.287 \text{ cm}^4)$
	$I_y=0.171 \text{ in}^4 (7.118 \text{ cm}^4)$

MACHINE SERVICES

CTL	670502
Access Hole 7.9mm	670518
Access Hole 11mm	670519
Tap M8	670511

BEAM SELECTION BY LOAD AND LENGTH

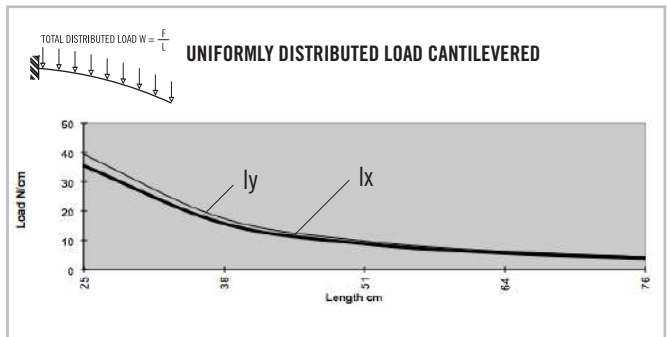
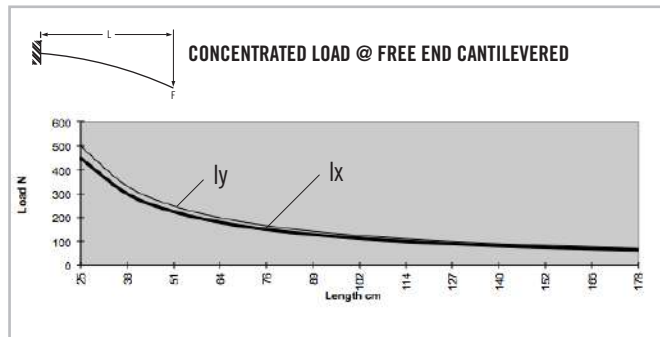
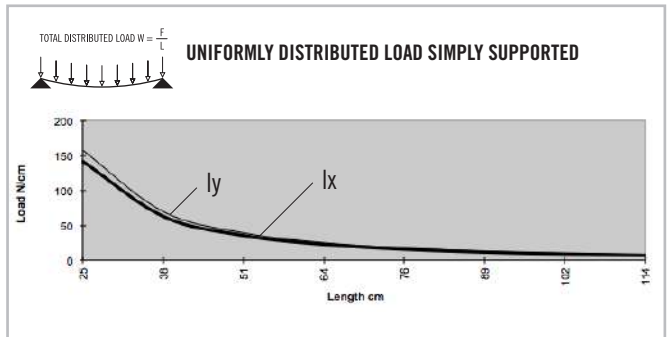
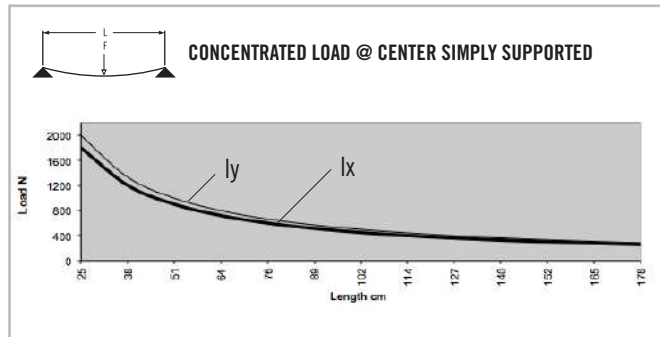

* Charts based on allowable loads related to yield strength with a margin of safety equal to five.

» For deflection equations see page 10

TS30-45 C CHANNEL

Clear Anodized - 670086

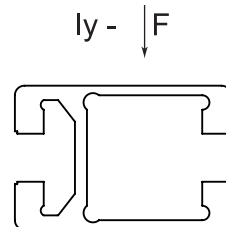
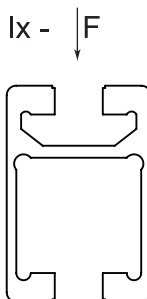
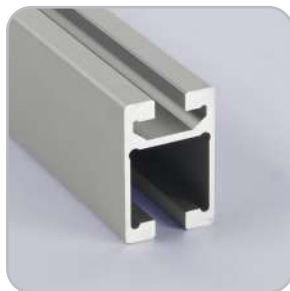
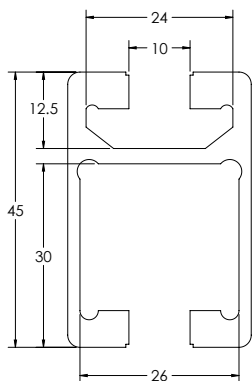

SPECIFICATIONS

Length	239" (6.07 m)
Weight	0.832 lbs/ft (1.238 kg/m)
Estimated Area	0.693 in ² (4.47 cm ²)
Moment of Inertia	0.255 I _x = in ⁴ (10.610 cm ⁴)
	0.136 I _y = in ⁴ (5.660 cm ⁴)

MACHINE SERVICES

CTL	670502
Access Hole 7.9mm	670518
Access Hole 11mm	670519

BEAM SELECTION BY LOAD AND LENGTH

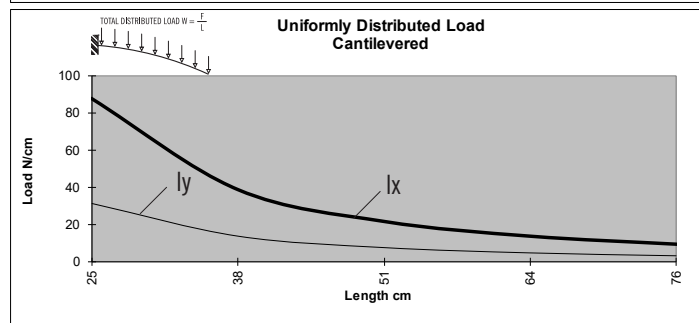
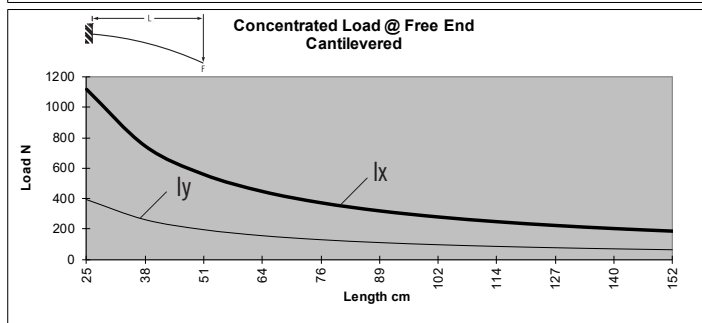
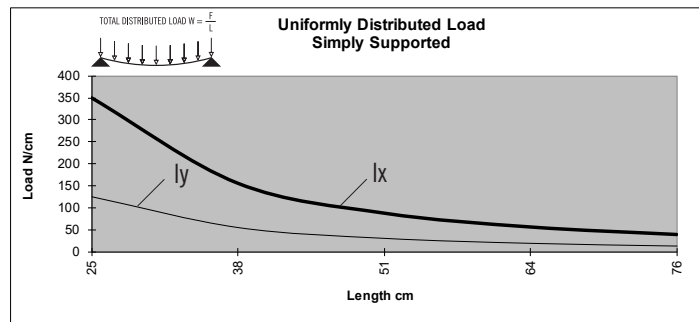
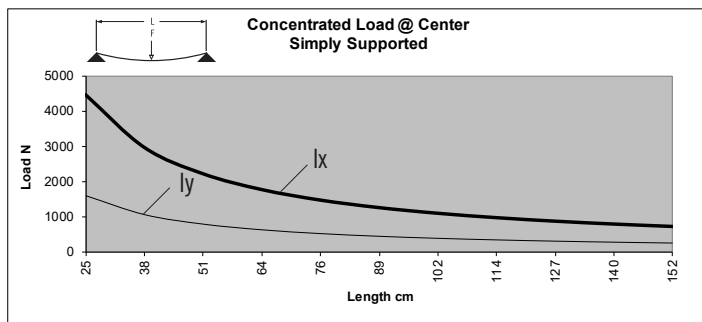

* Charts based on allowable loads related to yield strength with a margin of safety equal to five.

» For deflection equations see page 10